



Standard Windows System

Window configuration- fibreglass frame systems

BWTT 60

tilt & turn



- Hidden hardware;
- max dimensions: 1400mm x 2370mm to TT&SO&TO;
- max weight: Hidden hardware: 130kg
- max dimensions: 2600mm x 2370mm to SOaSO & SO&TT;
- max weight: Hidden hardware: 130kg one panel;
- Glass Thickness: 28mm; 35/36mm;
- standard Locks (Optional Key)

BWTT 60 TT

tilt & turn

Horizontal Section

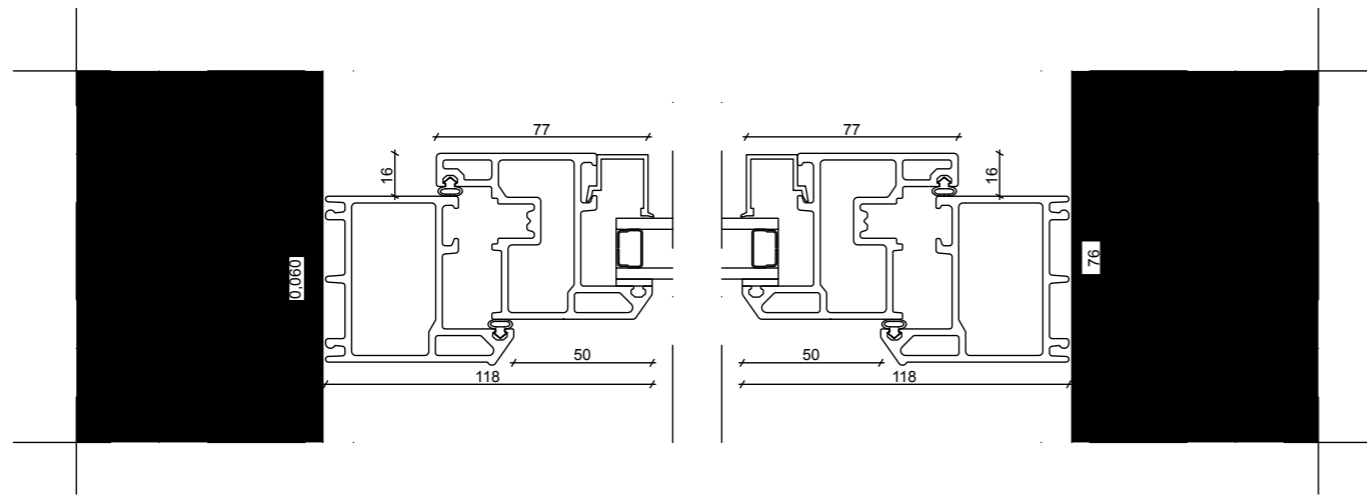
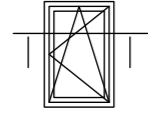

Vertical Section

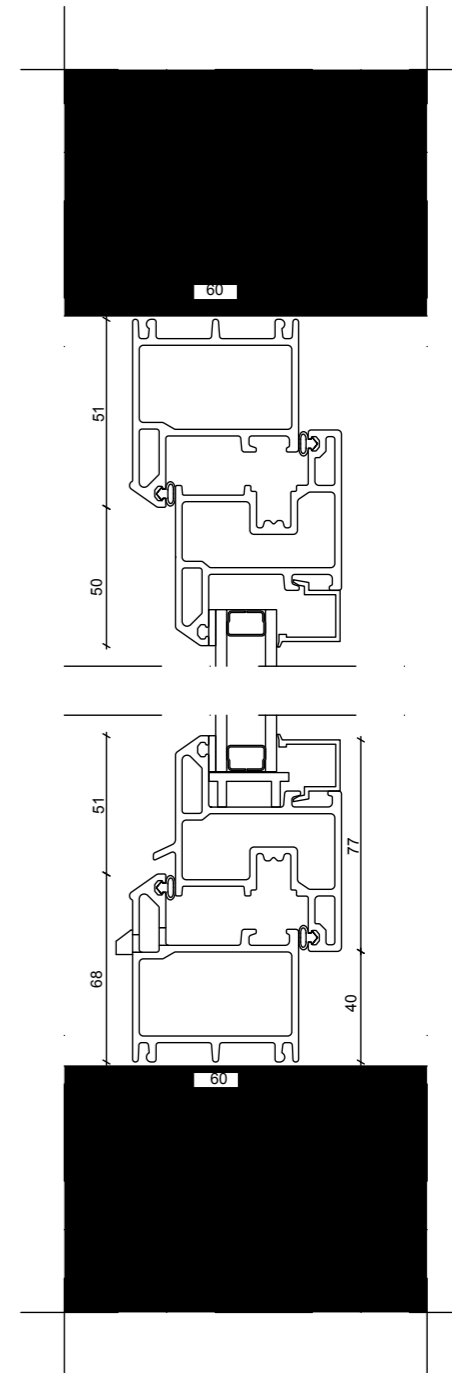

BWTT 60 TO

Top Opening

Horizontal Section

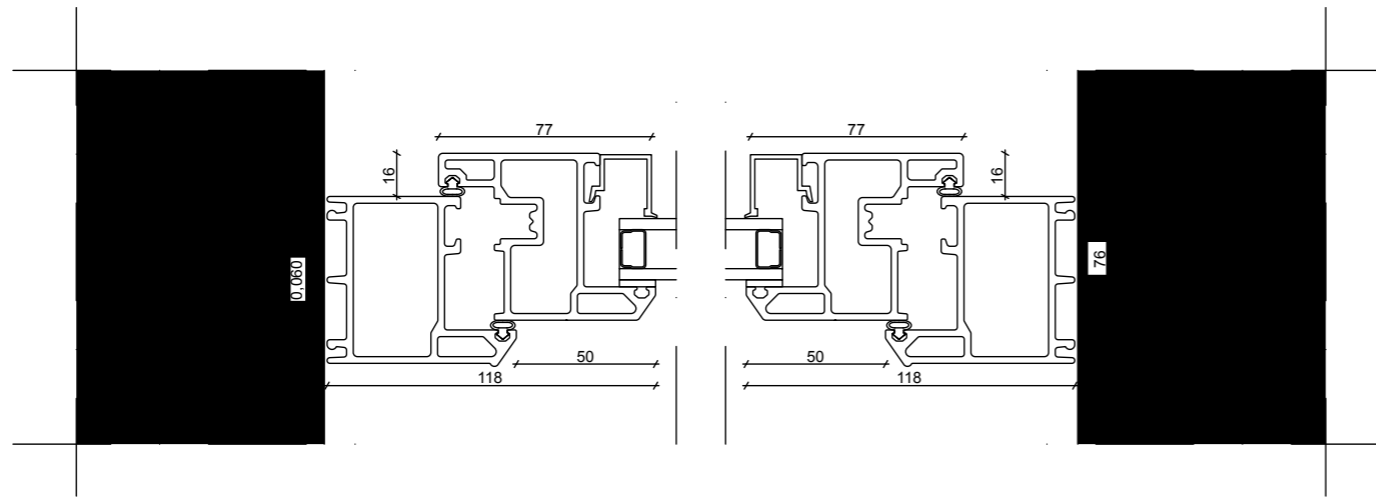
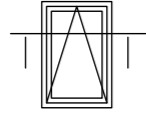

Vertical Section

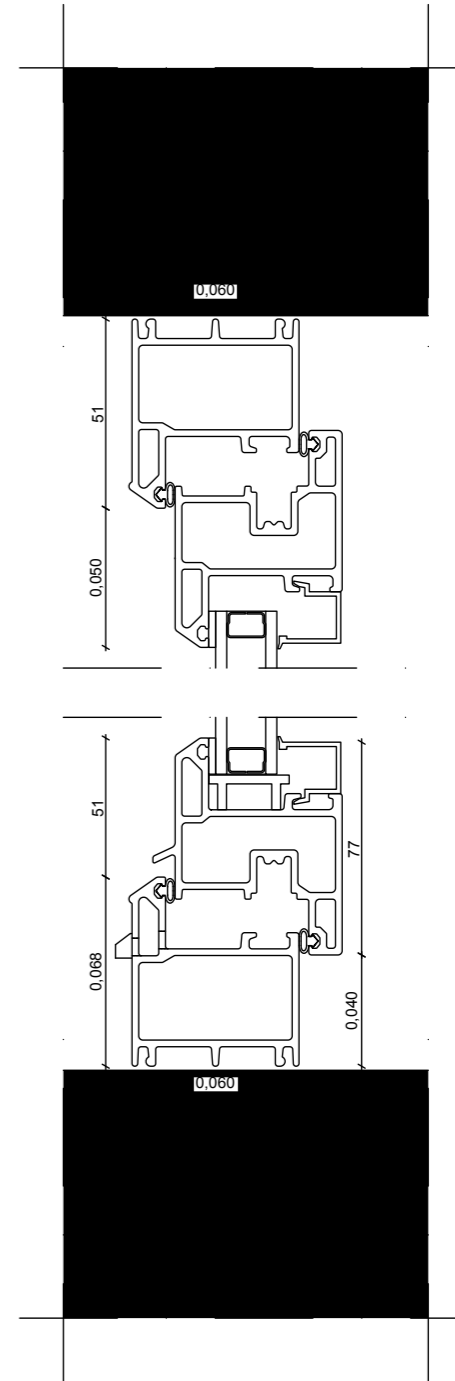

BWTT 60 SO

Side Opening

Horizontal Section

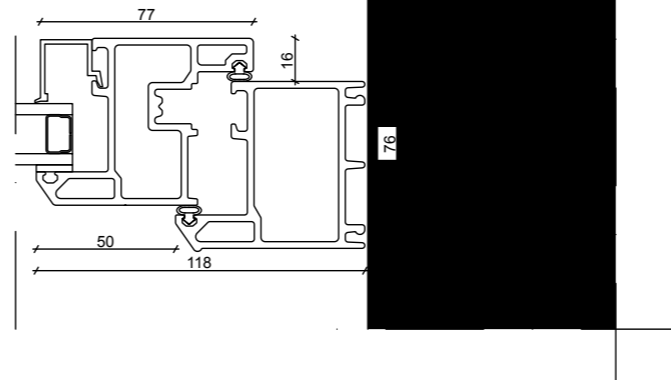
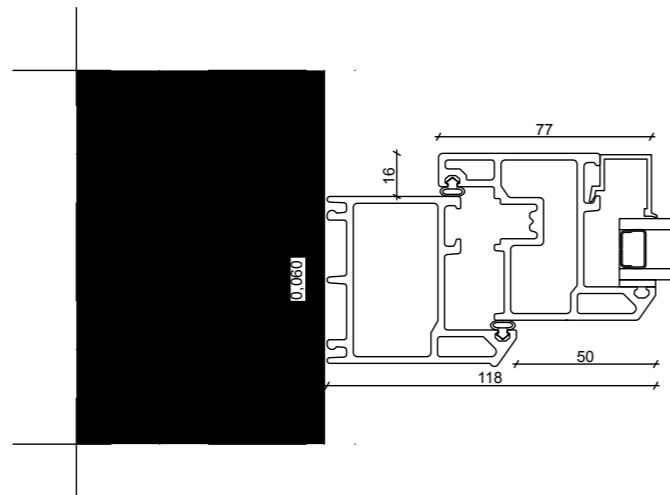

Vertical Section

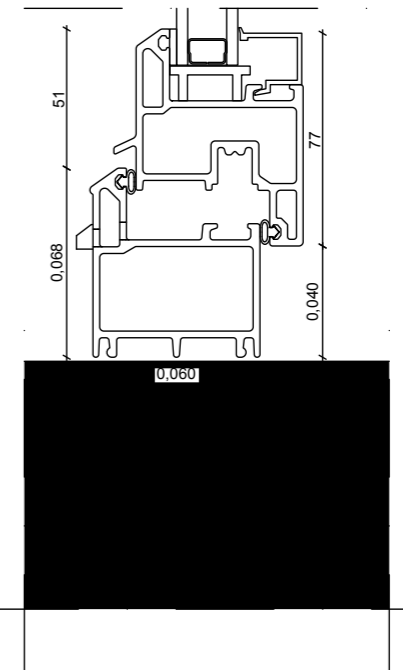
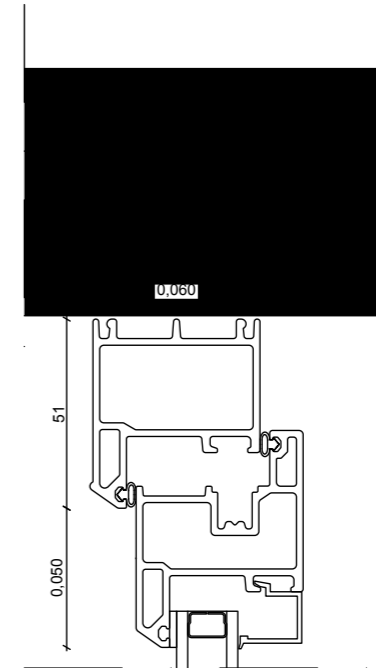

BWTT 60 FX

Fixed

Horizontal Section

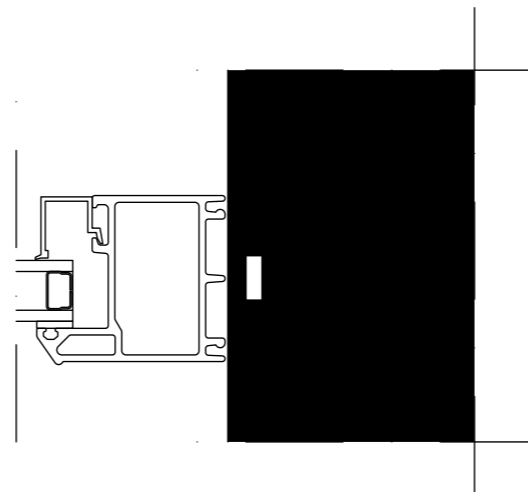
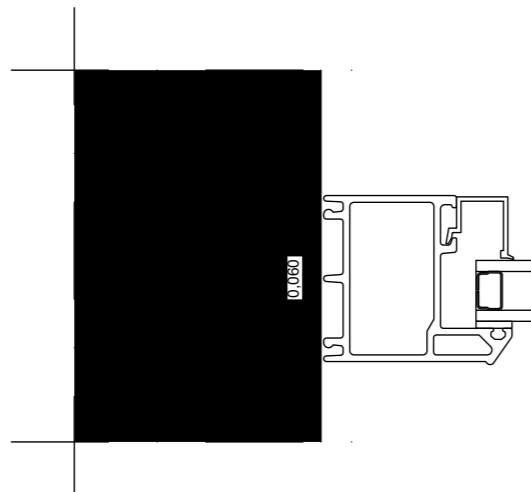
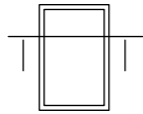

Vertical Section

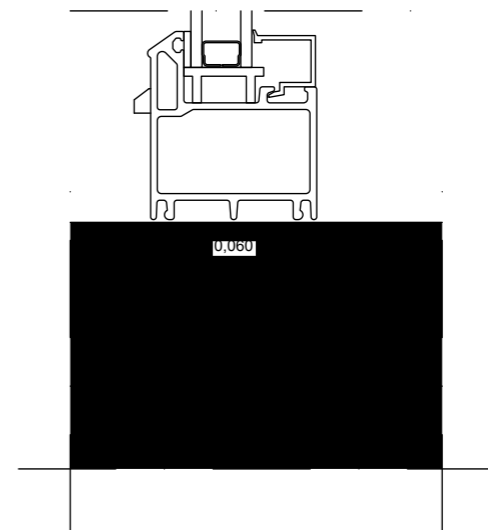
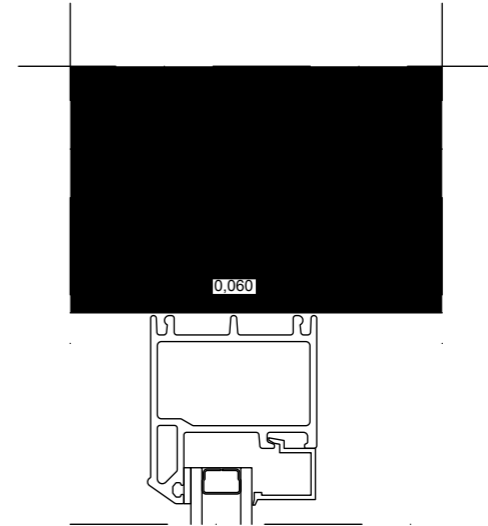
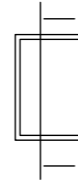

BWTT 60 FXvmFX

Fixed vertical mullion Fixed

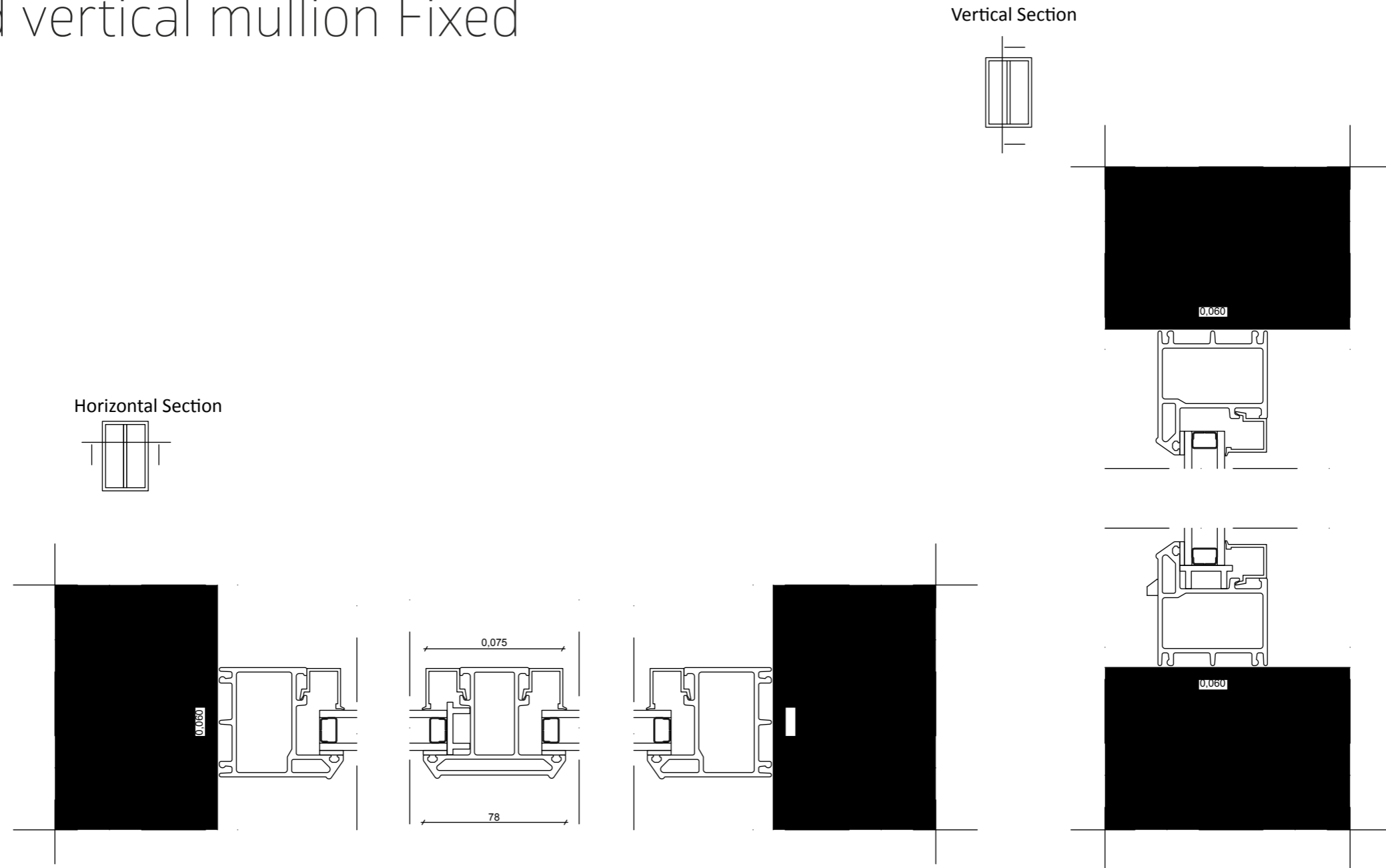

BWTT 60 TTvmFX FXvmTT

Tilt & Turn vertical mullion Fixed
 Fixed vertical mullion Tilt & Turn

Horizontal Section

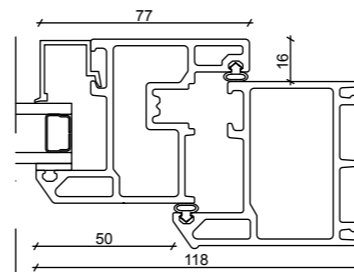
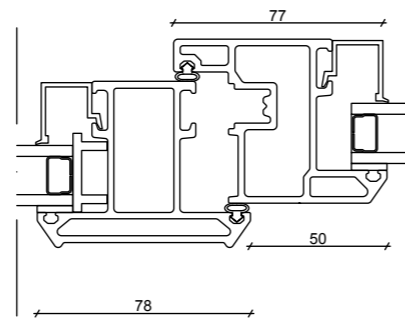
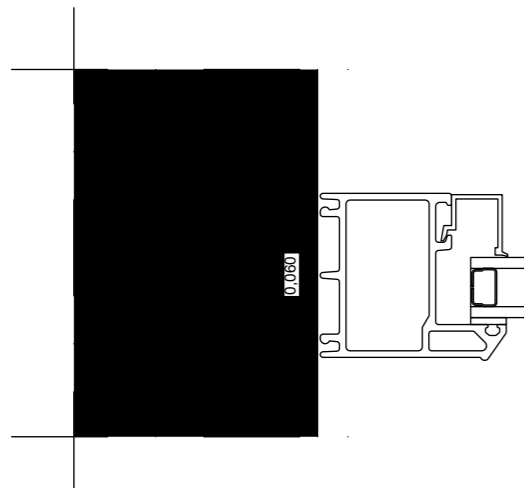
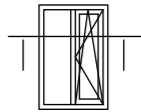

Vertical Section

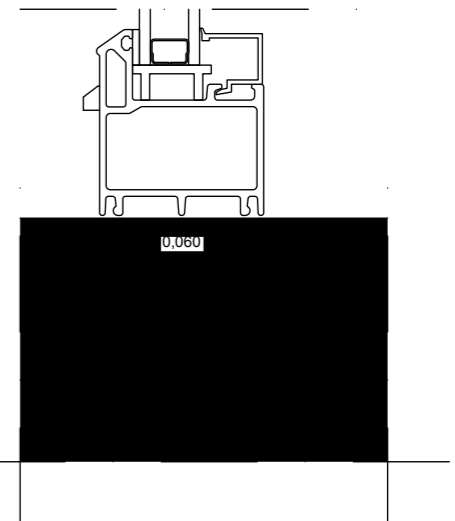
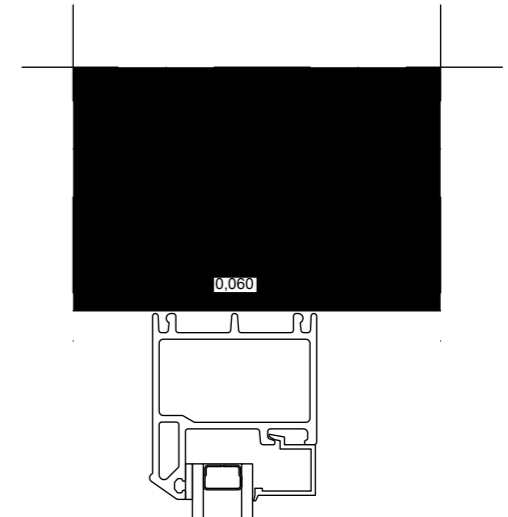
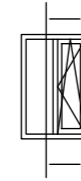

BWTT 60 SOvmFX FXvmSO

Side Opening vertical mullion Fixed
 Fixed vertical mullion Side Opening

Horizontal Section

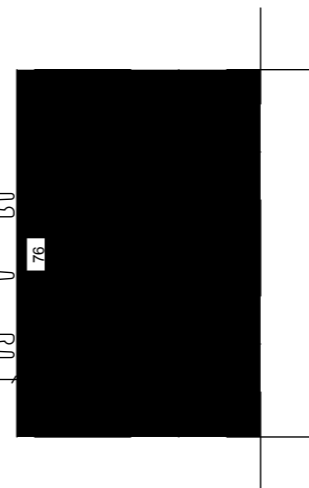
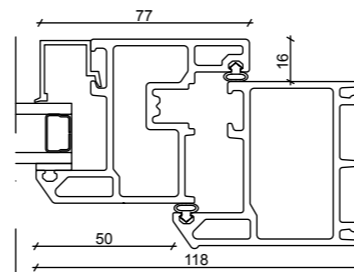
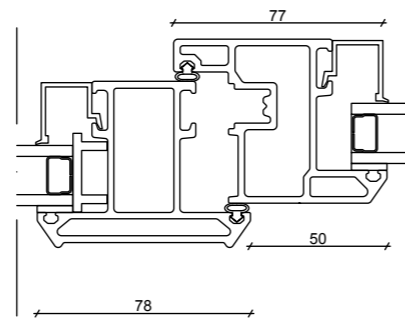
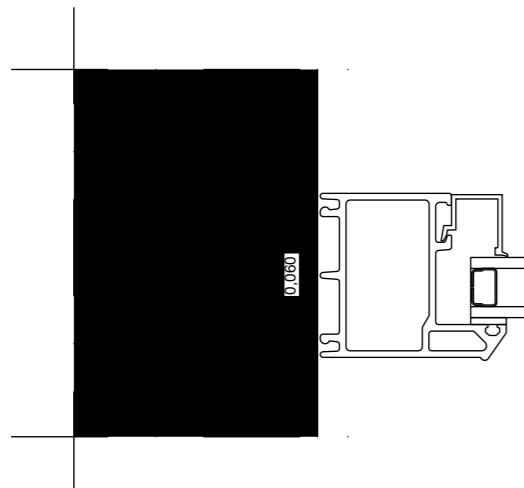
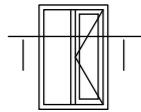

Vertical Section

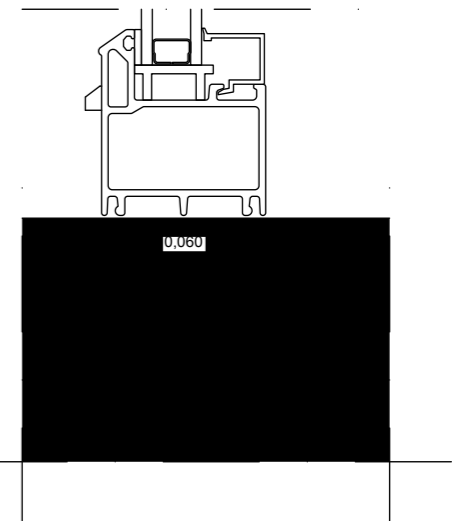
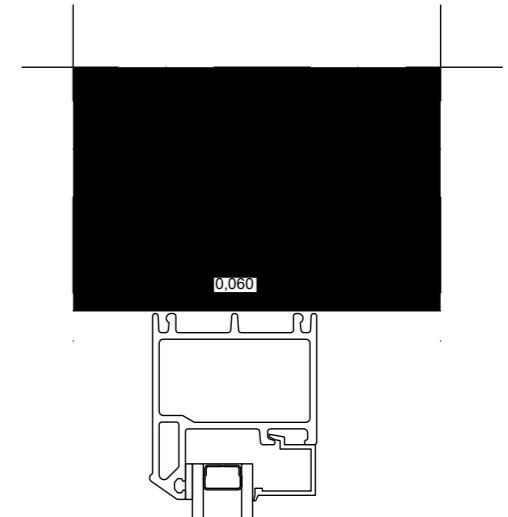

BWTT 60 TOvmFX FXvmTO

Top Opening vertical mullion Fixed
 Fixed vertical mullion Top Opening

Horizontal Section

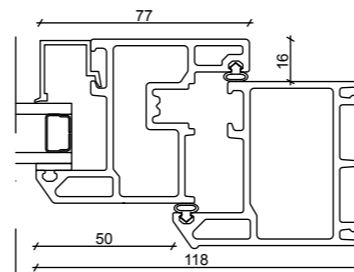
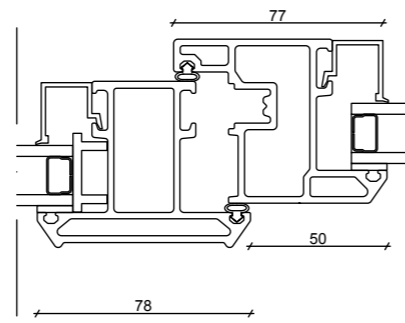
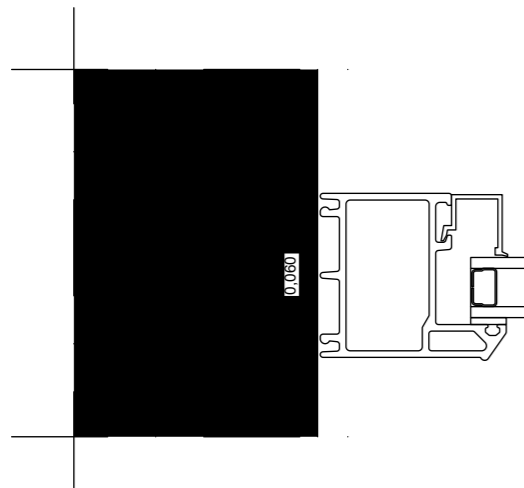
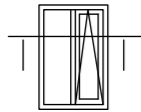

Vertical Section

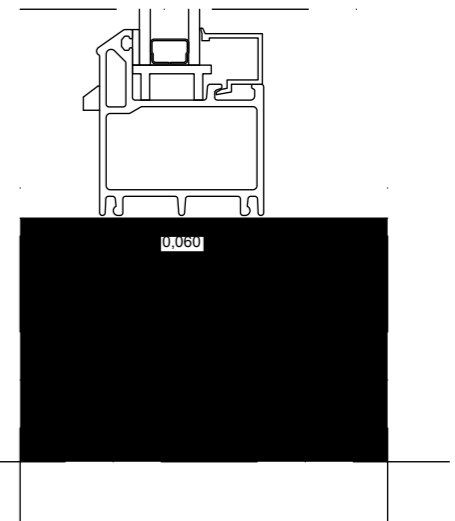
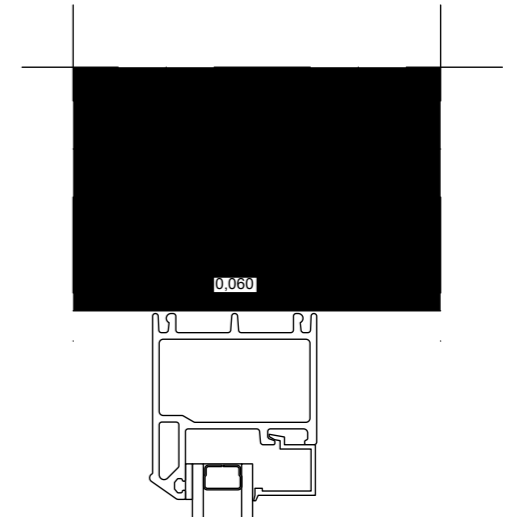

BWTT 60 FXhmFX

Fixed Horizontal mullion Fixed

Vertical Section

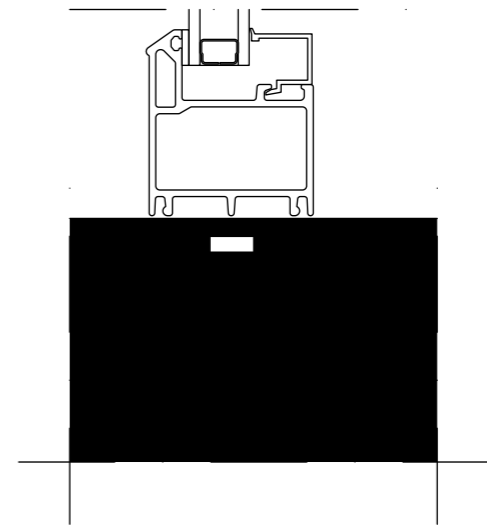
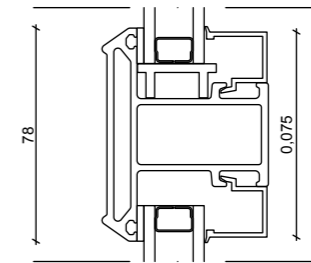
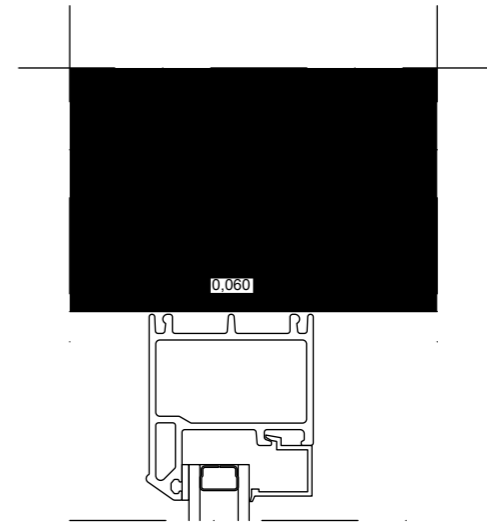

Horizontal Section

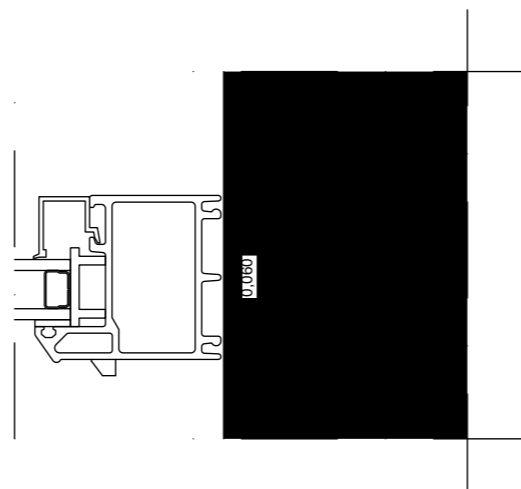
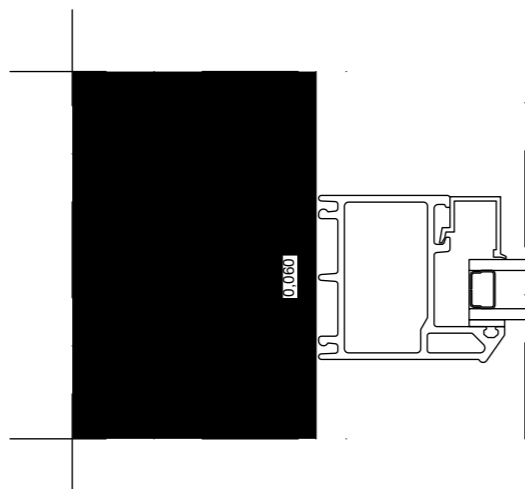
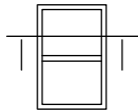

BWTT 60 TOhmFX

Top Opening Horizontal mullion Fixed

Vertical Section

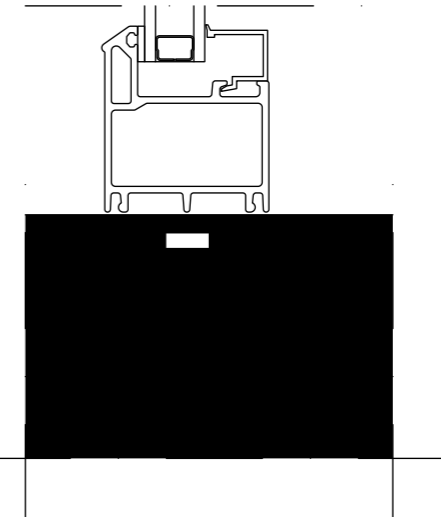
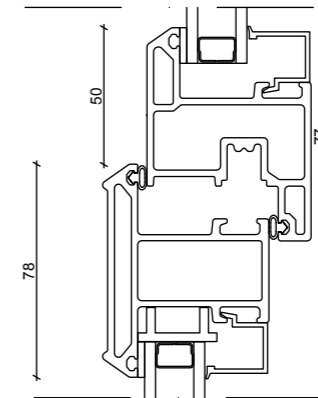
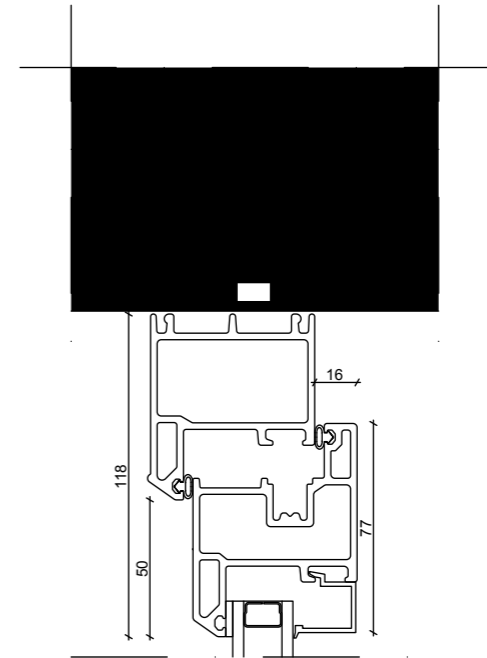

Horizontal Section

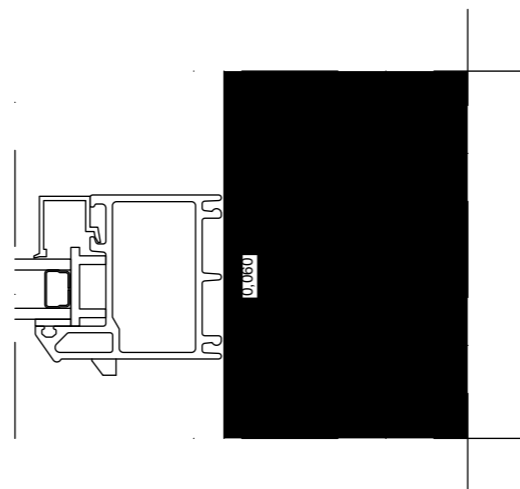
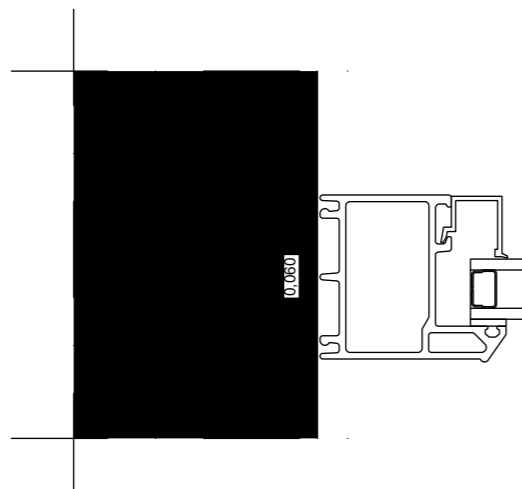
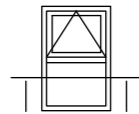

BWTT 60 TTaSO SOaTT

Tilt&turn astragal Side Opening
 Side Opening astragal Tilt&turn

Vertical Section

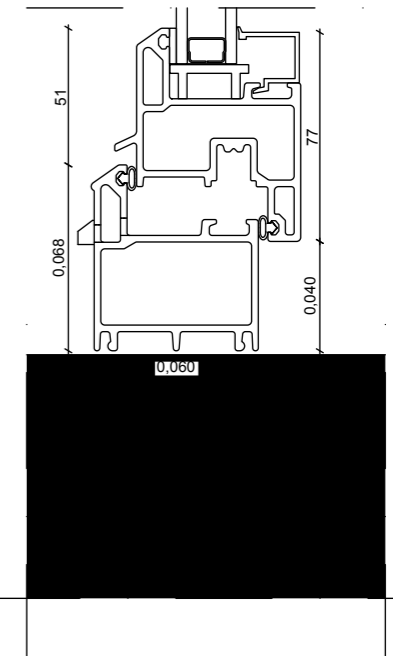
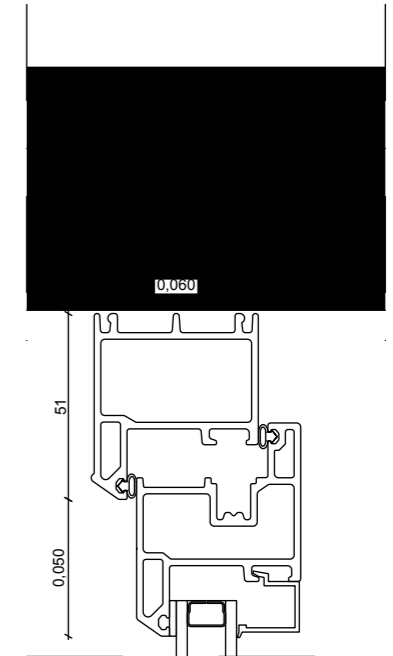
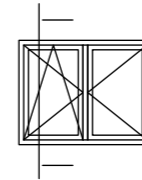

Horizontal Section

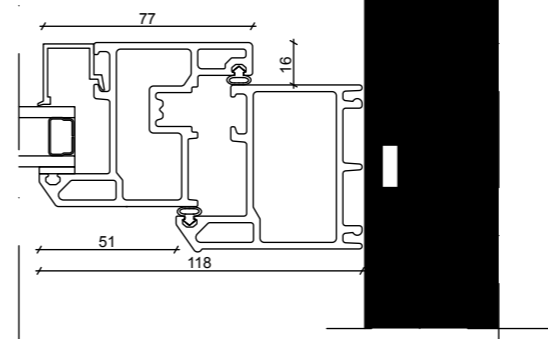
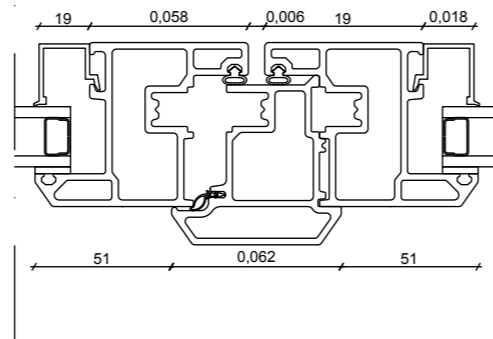
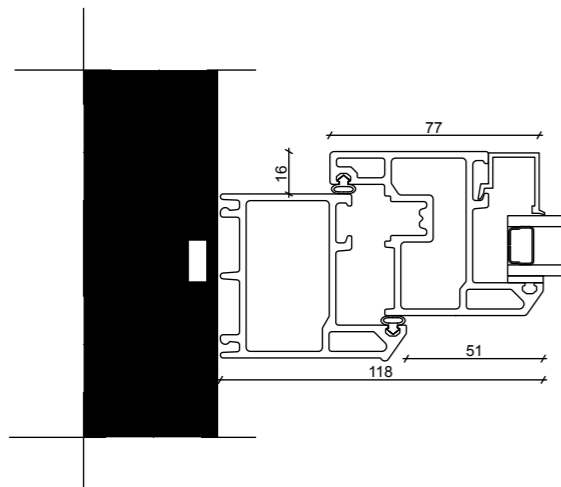
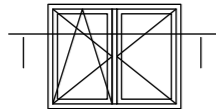

BWTT 60 SOaSO

Side Opening astragal Side Opening

Vertical Section

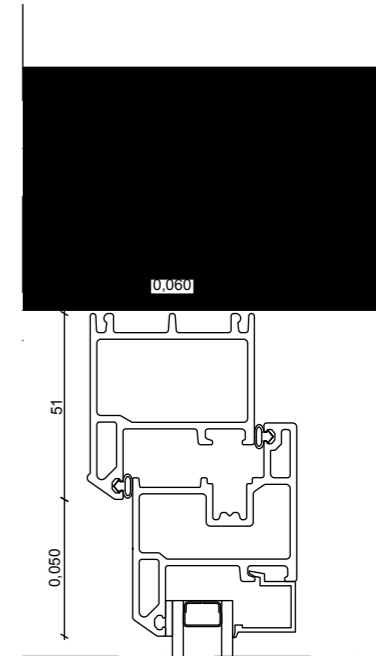
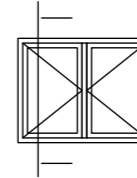

Horizontal Section

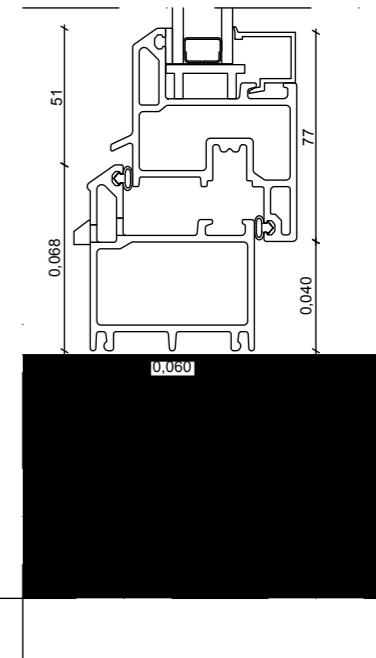
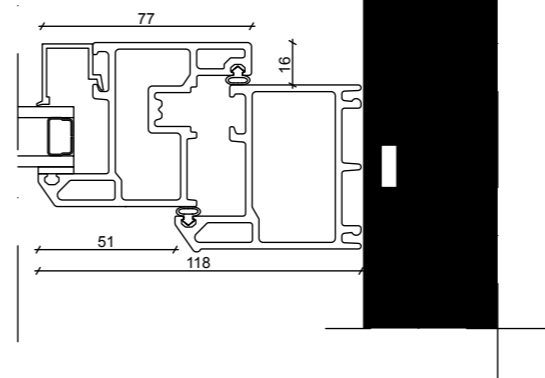
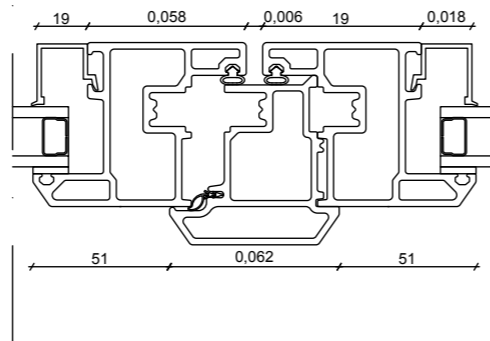
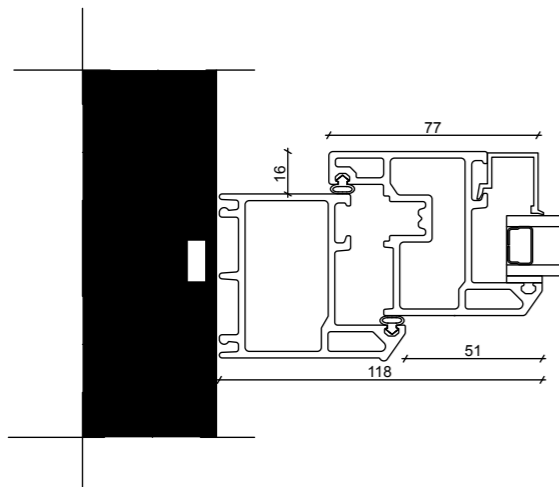
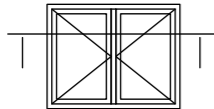

BWD 60

Door



- Visible hinges;
- Max dimensions: 1200 mm (w) x 2400mm (SO)
- Max dimensions: 2400 mm (w) x 2400mm (SOaSO)
- Max weight: 180 kg per panel
- Glass thickness: 28mm and 35/36mm;
- 3 points lock as standard; handle in standard colours (white, black, stainless steel finish) with TESA key;
- 4 points lock as option.

BWD 60 50

Side Opening

Vertical Section

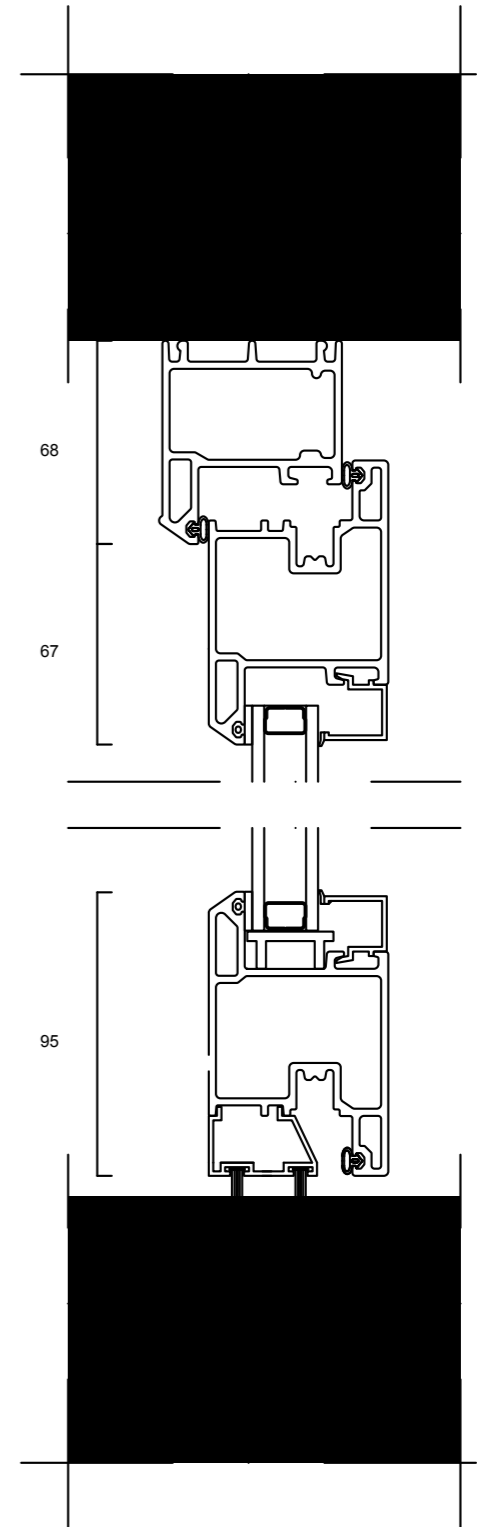

Horizontal Section

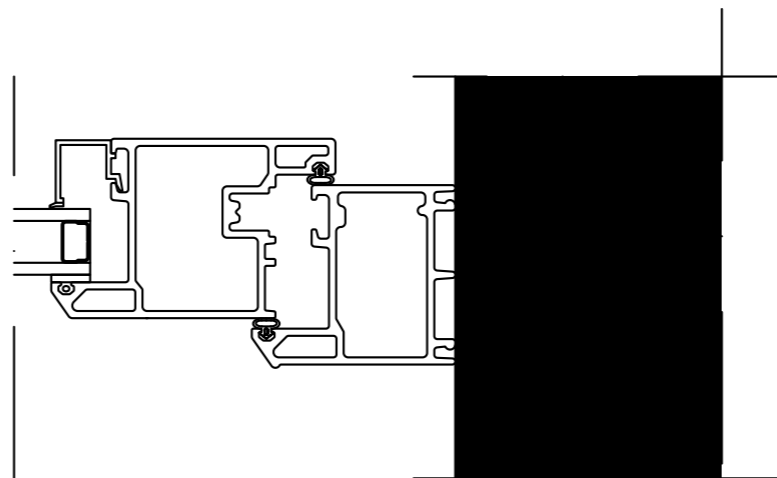
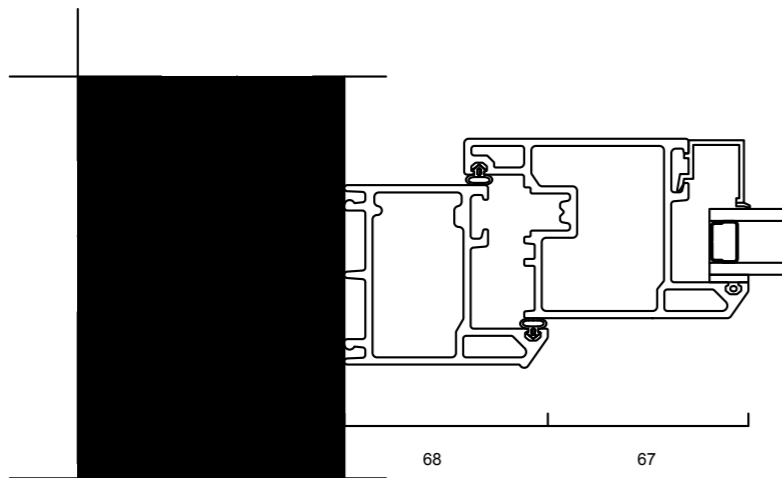
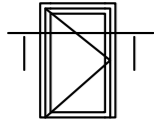

BWD 60

Vertical Section

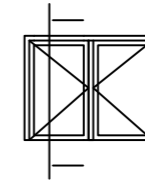

Horizontal Section

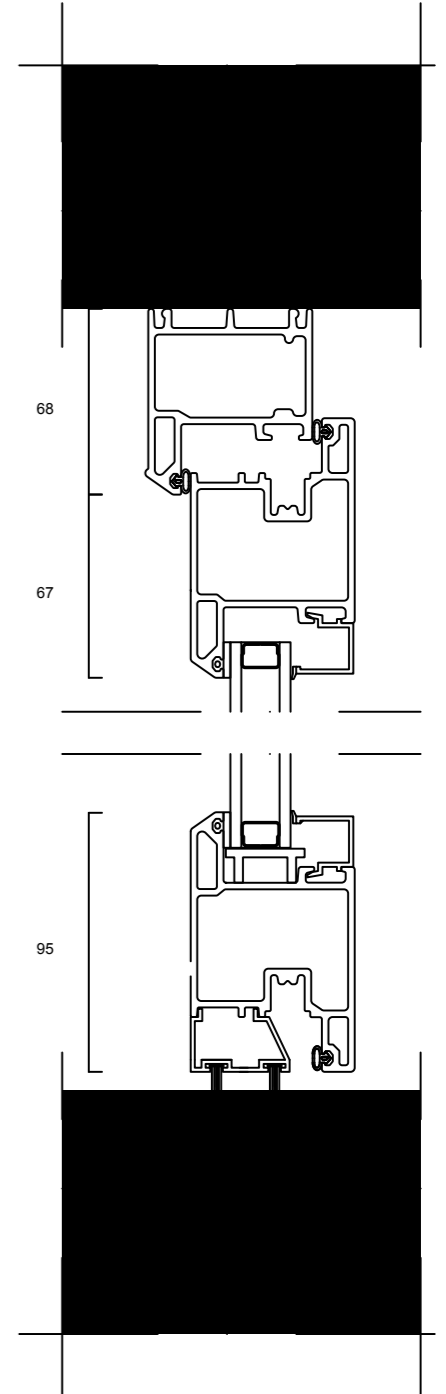
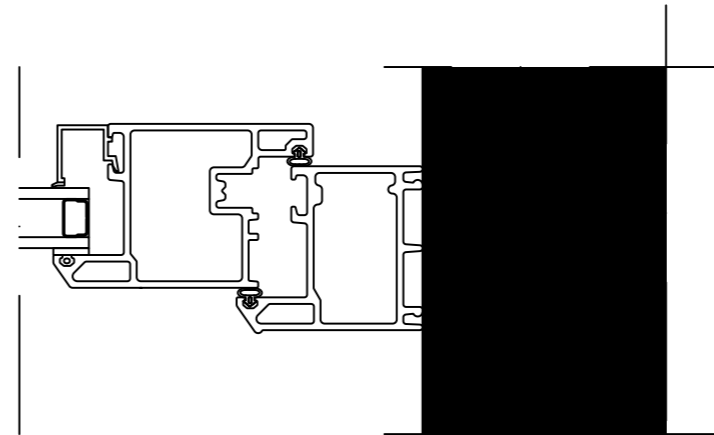
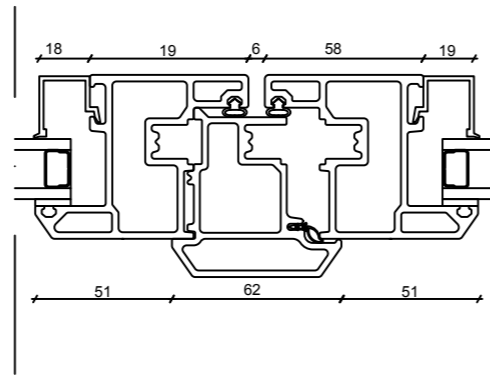
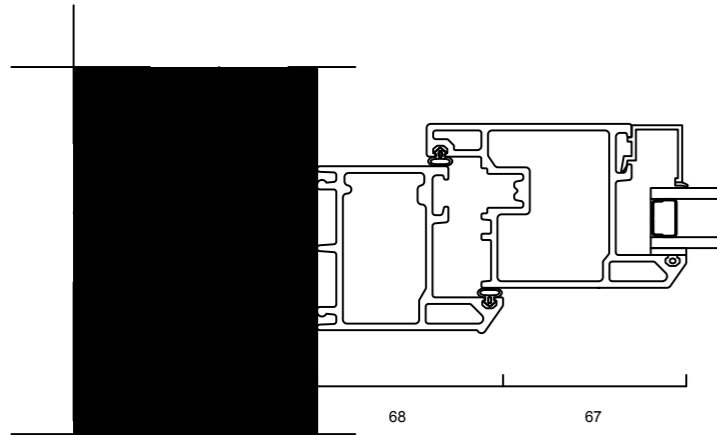
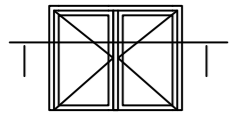

BWSL 45

Sliding



- Max dimensions:
 - 2 panel: 4000mm (w) x 1650 mm (h);
 - 3 panel: 5750mm (w) x 1650 mm (h);
- One, two or three rails;
- Max locking points: 3;
- Latch as standard, lock as option;
- Latch on inside only as standard;
- Large handle as option;
- Glass thickness: 28mm, 36 mm.

BWSL 45 2R MM 2R FM 2R MF

Two rails Movable panel Movable panel
 Two rails Fixed panel Movable panel
 Two rails Movable panel Fixed panel

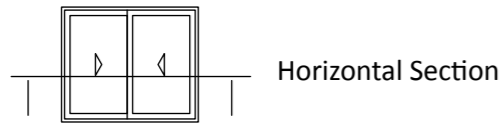

Horizontal Section

Vertical Section

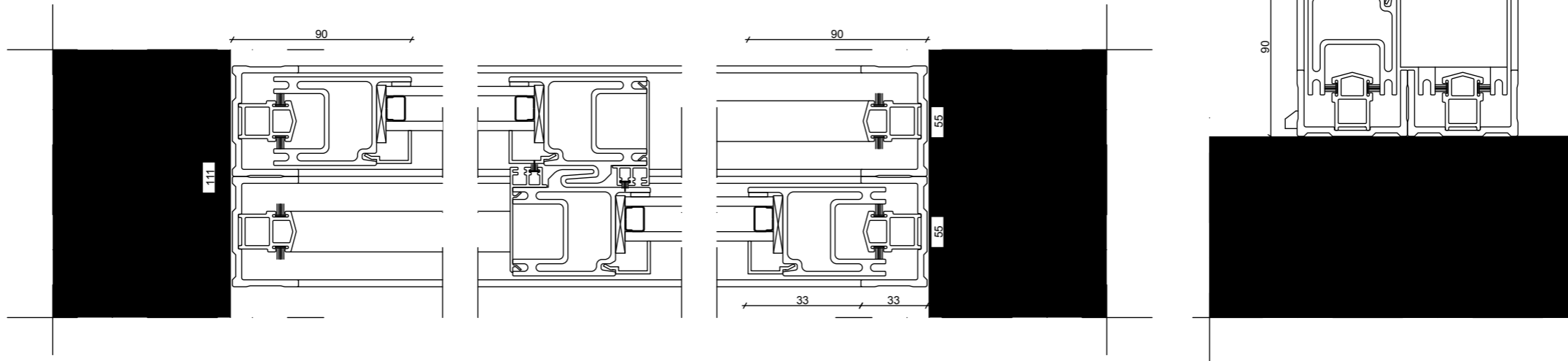
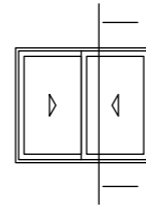

BWSL 45 3R MMM 3R MMF 3R FMM

Three rails Movable panel - Movable panel - Movable panel
 Three rails Fixed panel Movable panel - Movable panel
 Three rails Movable panel - Movable panel Fixed panel

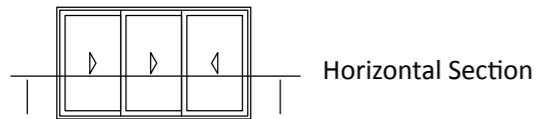

Vertical Section

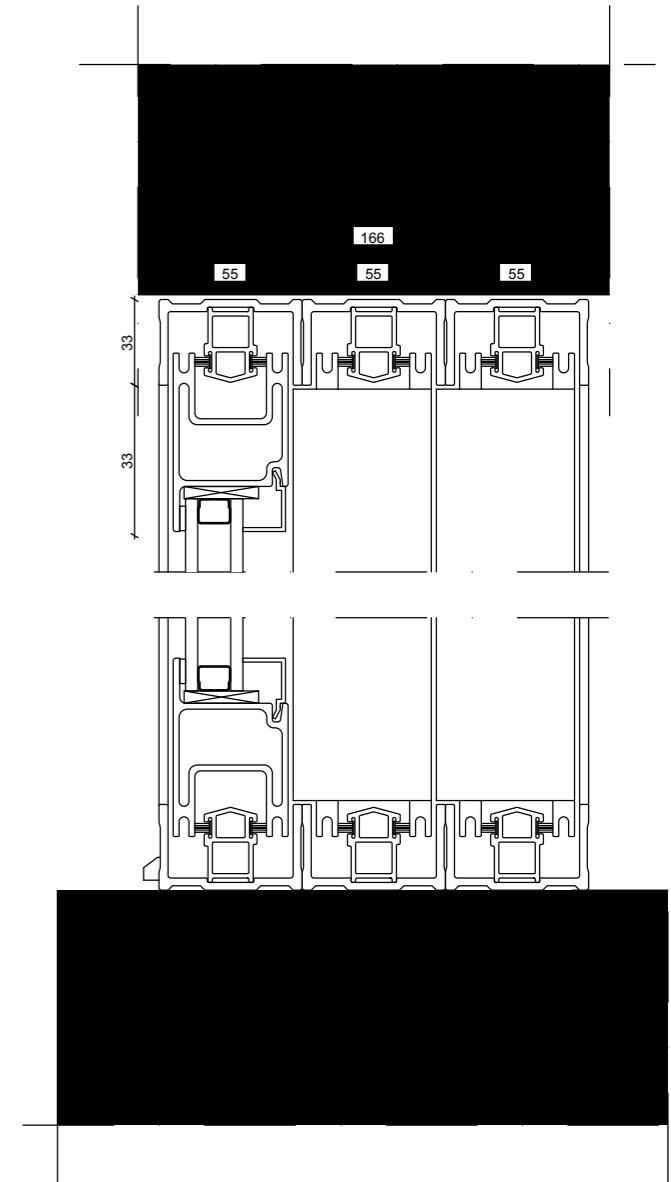
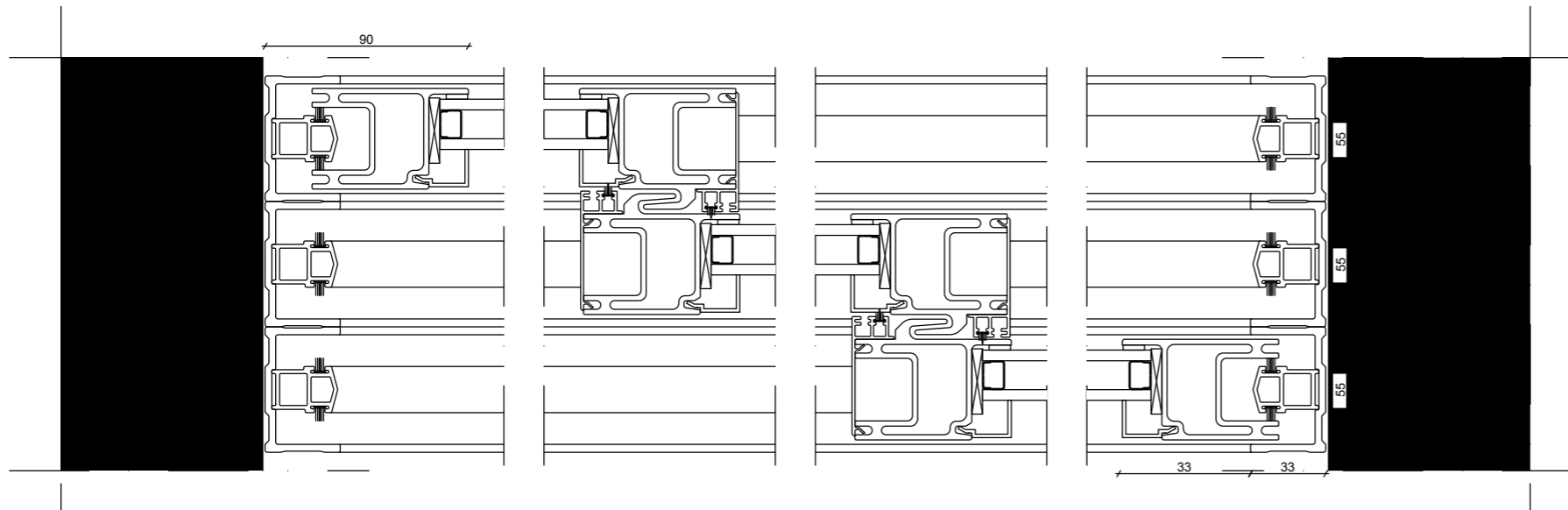
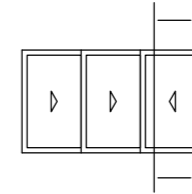

BWDSL 45

Sliding



- Max dimensions:
 - 2 panel: 4000mm (w) x 2650 mm (h);
 - 3 panel: 5750mm (w) x 2650 mm (h);
- One, two or three rails;
- Max weight per panel: 250kg;
- Max locking points: 3;
- Latch as standard, lock as option;
- Latch on inside only as standard;
- Large handle as option;
- Glass thickness: 28mm, 36 mm;
- Includes fibreglass drainage system.

BWDSL 45 2R MM

Two rails - Movable panel - Movable panel

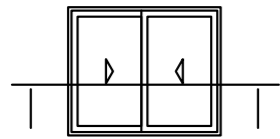

Horizontal Section

Vertical Section

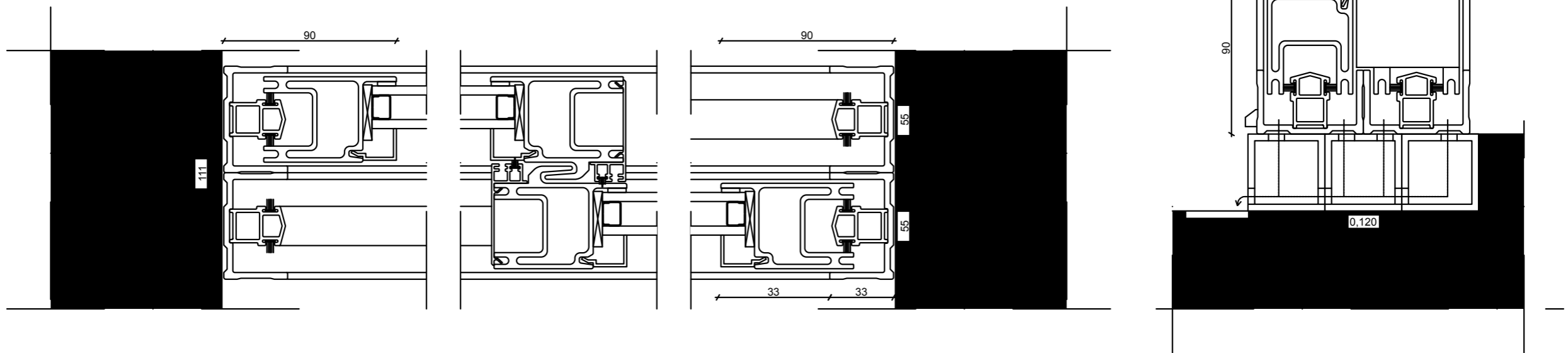
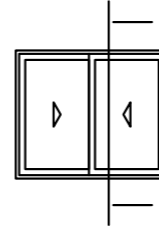

BWDSL 45 2R MF

Two rails - Movable panel - Fixed panel

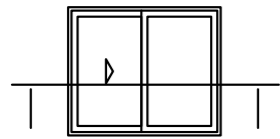

Horizontal Section

Vertical Section

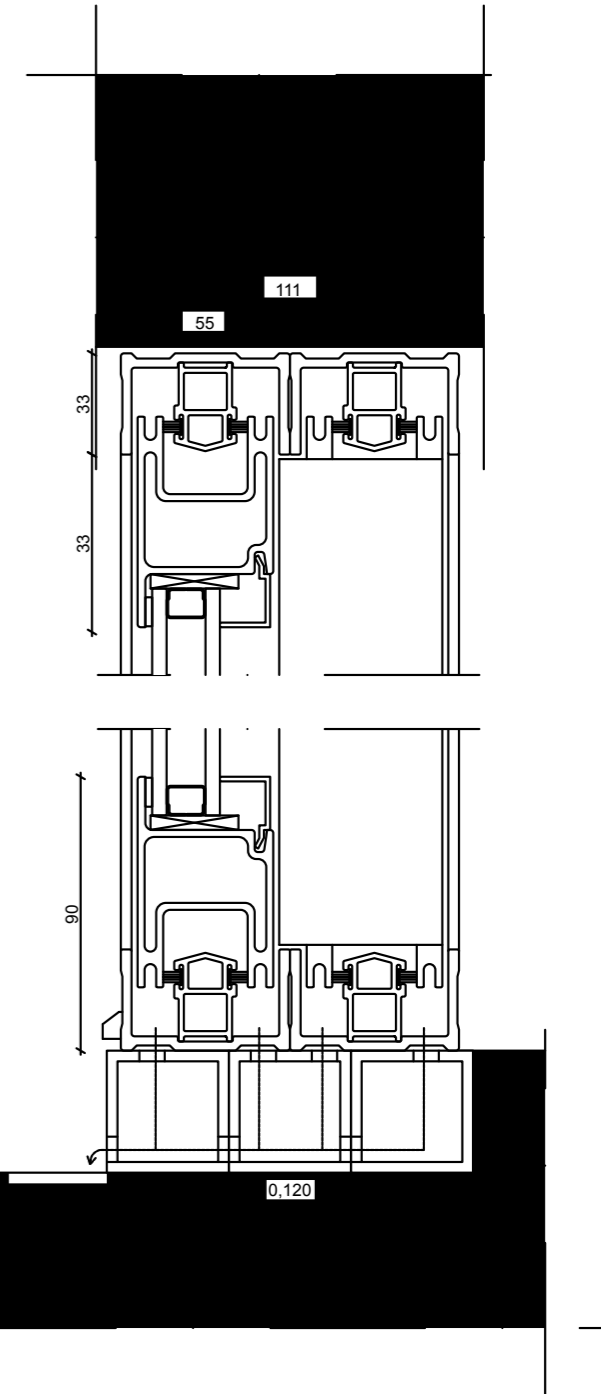
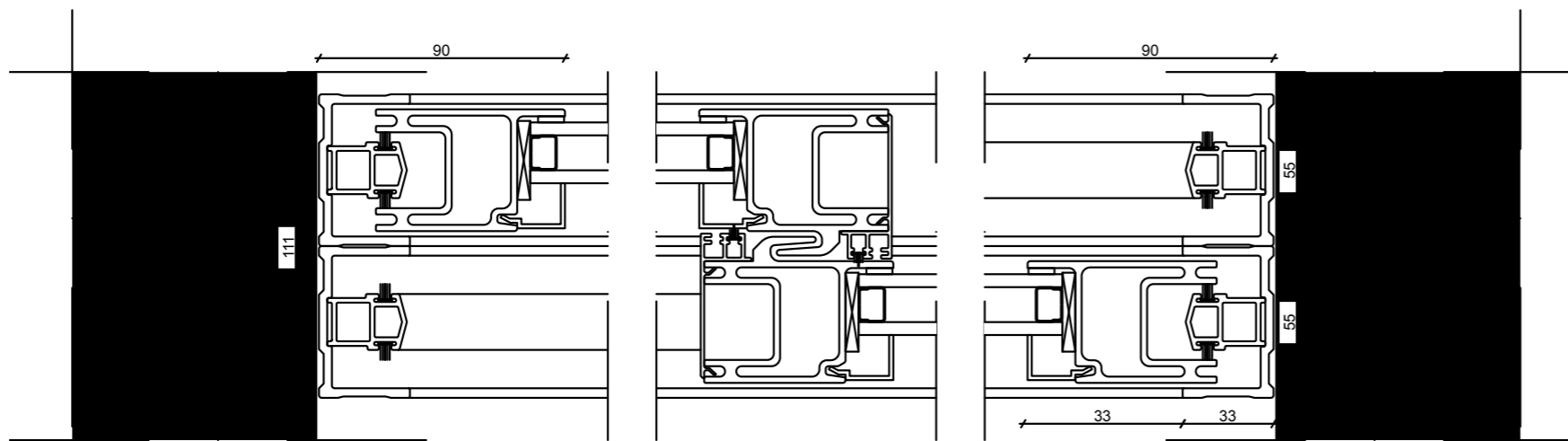
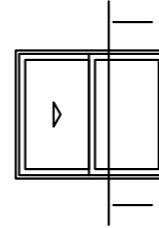

BWDSL 45 2R FM

Two rails - Fixed panel - Movable panel

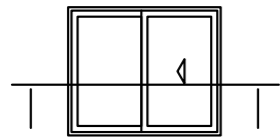

Horizontal Section

Vertical Section

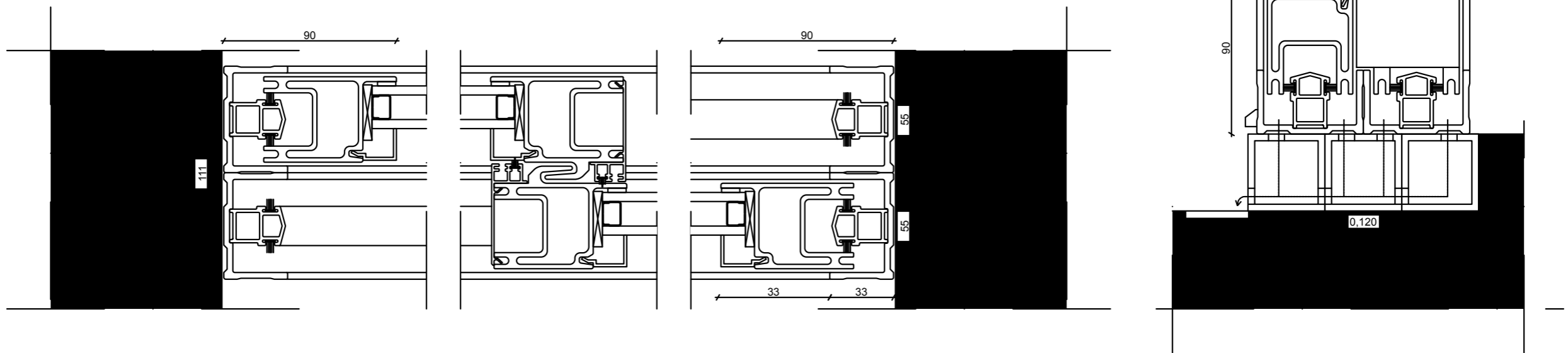
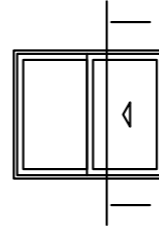

BWDSL 45 3R MMM

Three rails - Movable panel - Movable panel - Movable panel

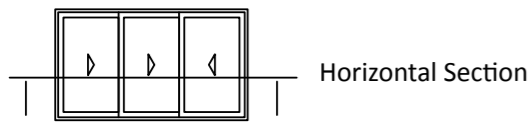

Vertical Section

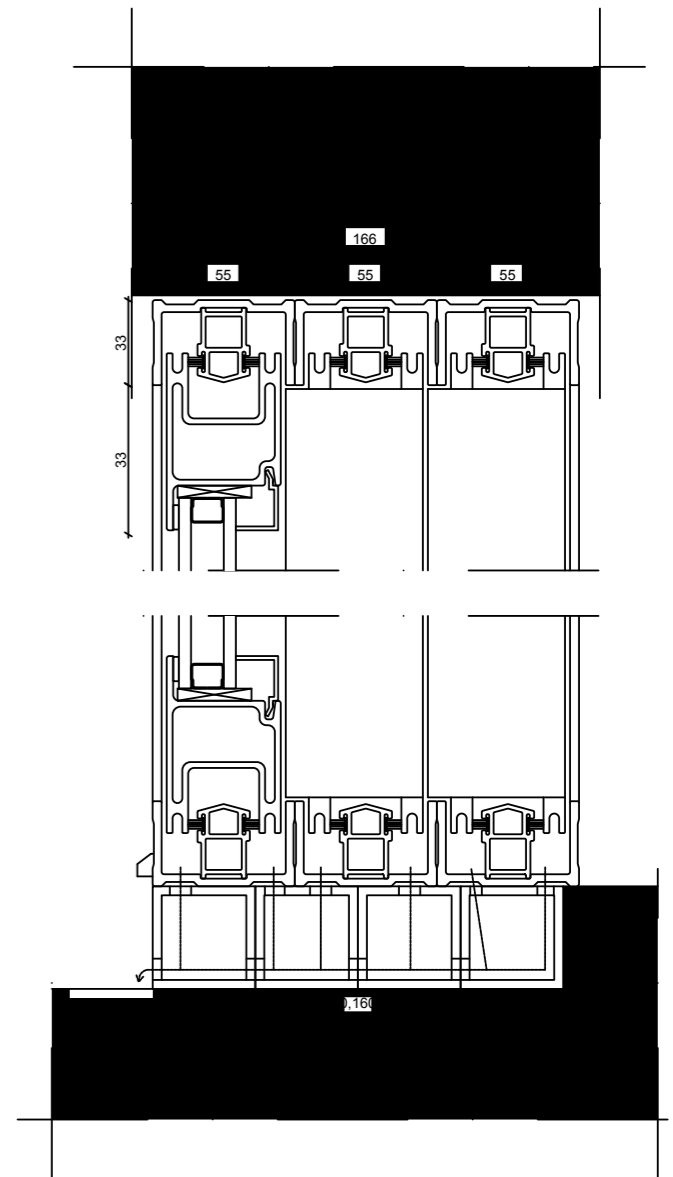
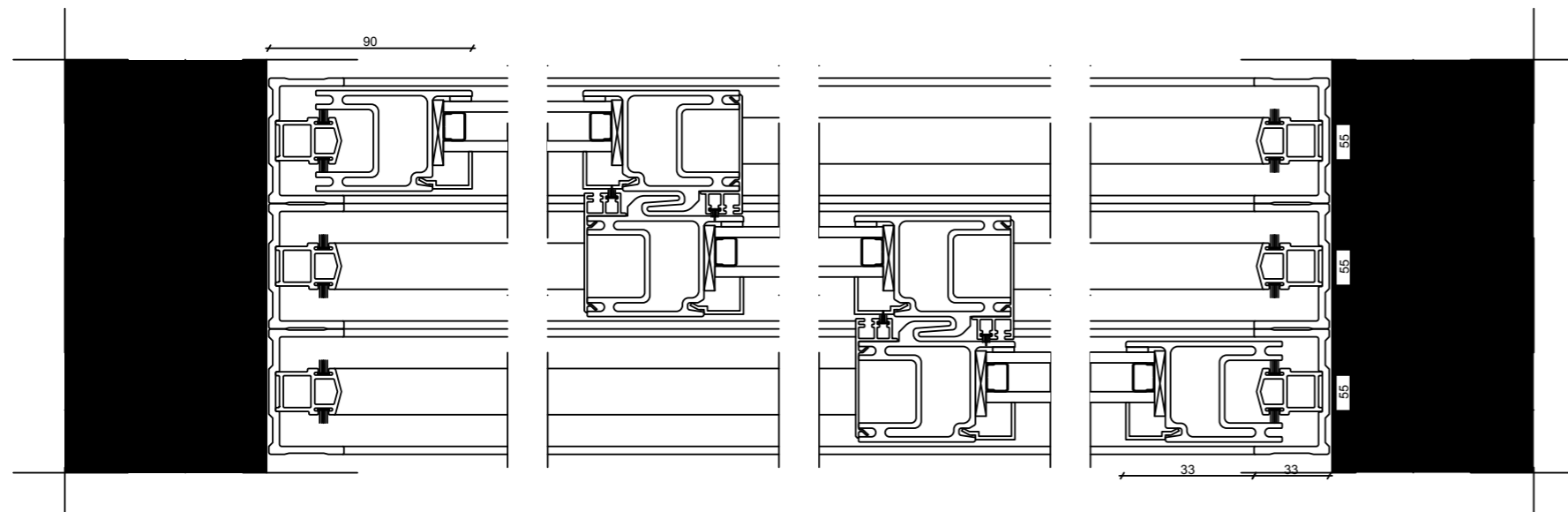
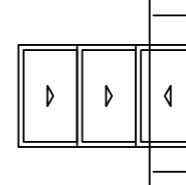

BWDSL 45 3R MMF

Three rails - Movable panel - Movable panel - Fixed panel

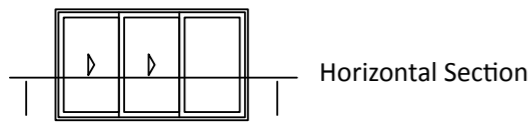

Vertical Section

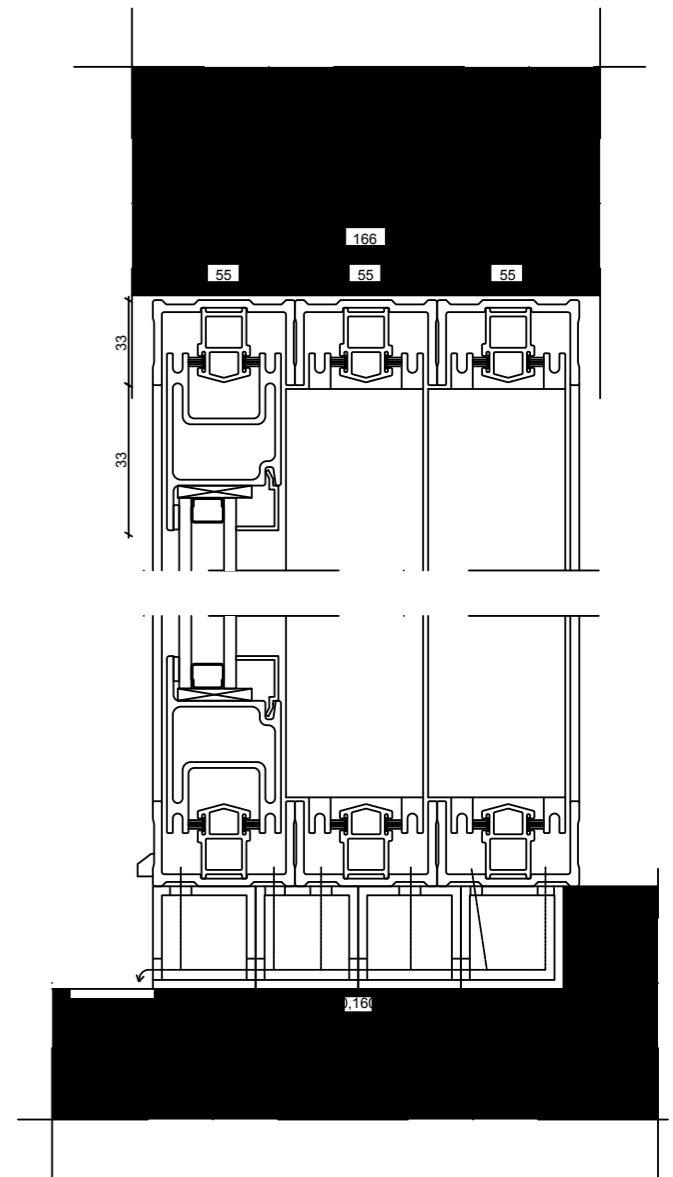
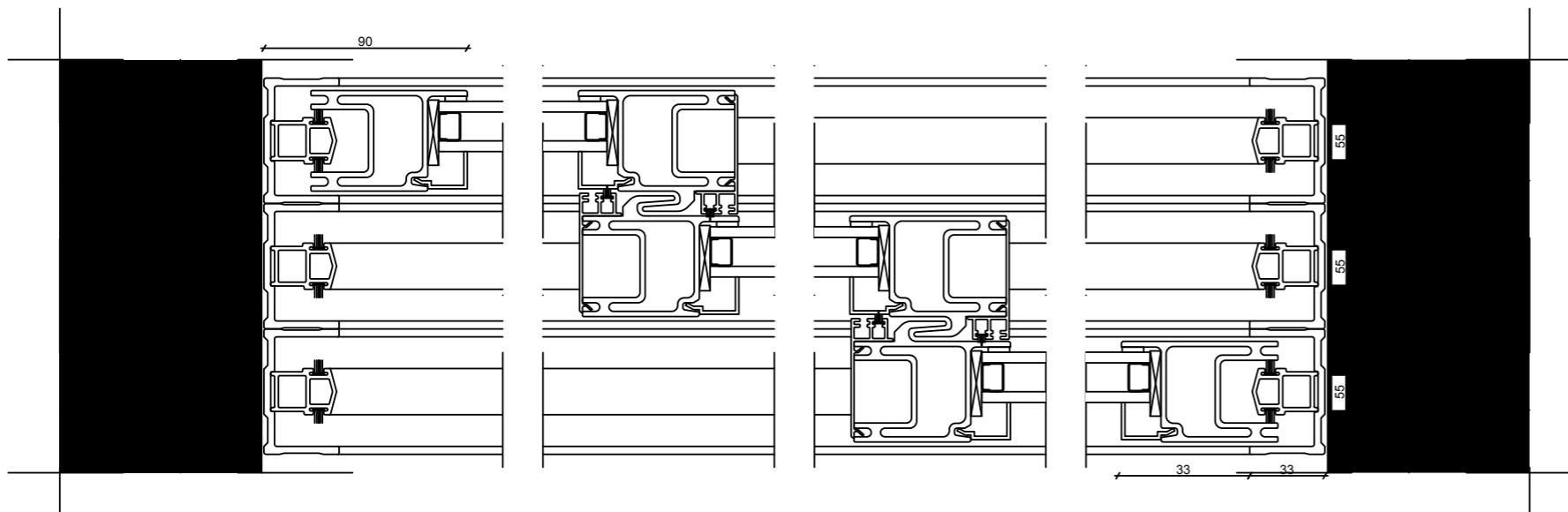
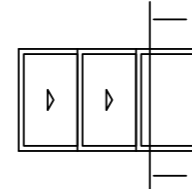

BWDSL 45 3R FMM

Three rails - Fixed panel - Movable panel - Movable panel

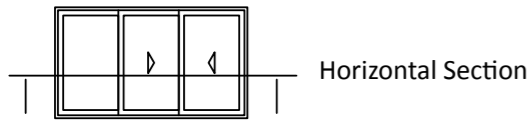

Vertical Section

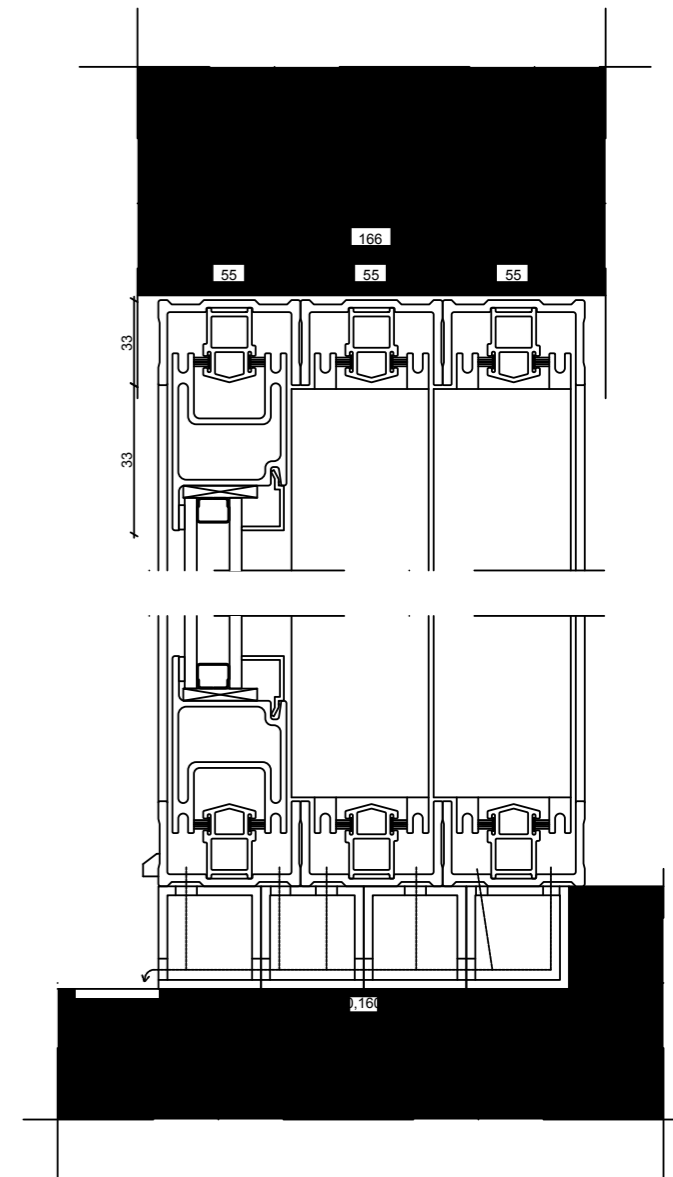
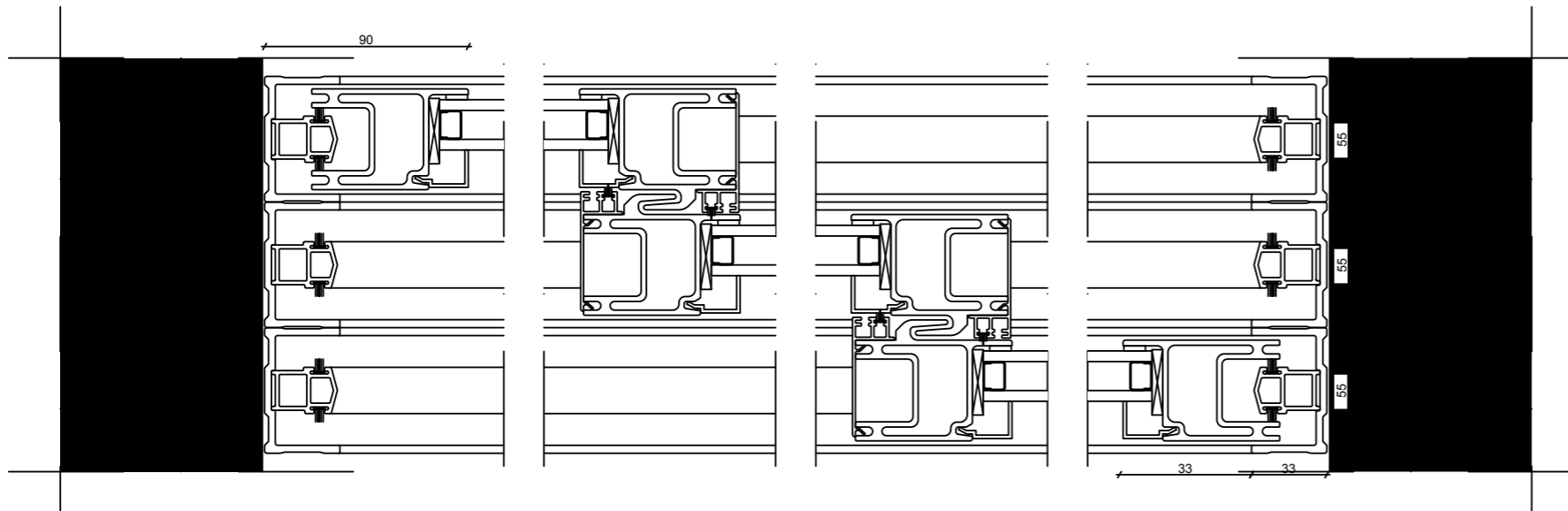
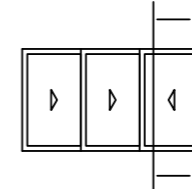

BWS 35

Sash



- max dimensions: 1200mm x 2000mm;
- max weight: 30kg each panel;
- Glass Thickness: 22mm, 28mm;
- Latch as standard. Lock as option

BWS 35

Sash 1

Horizontal Section

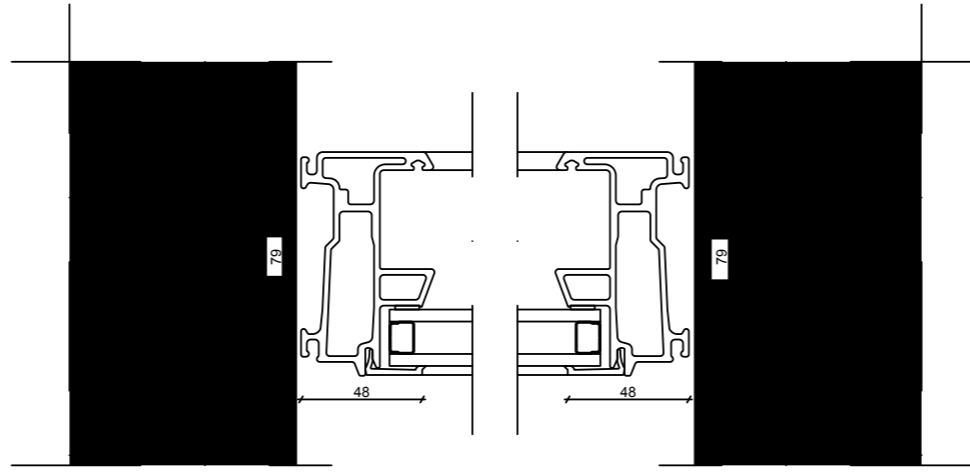
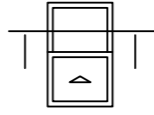

Vertical Section

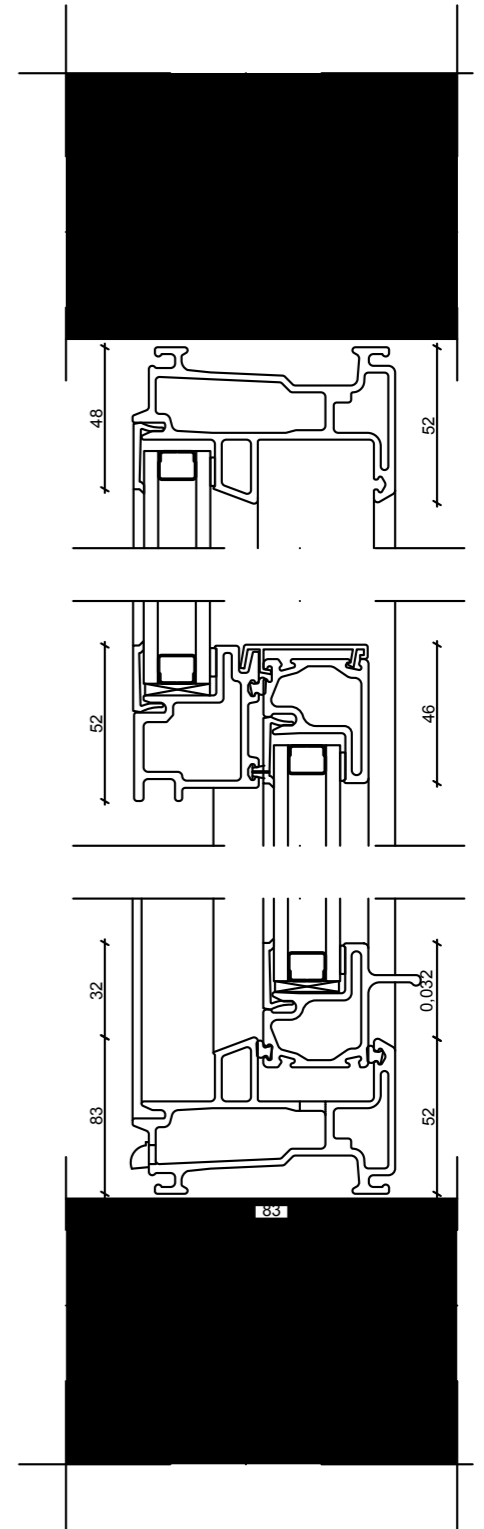
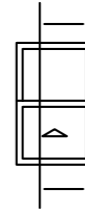

Horizontal Section

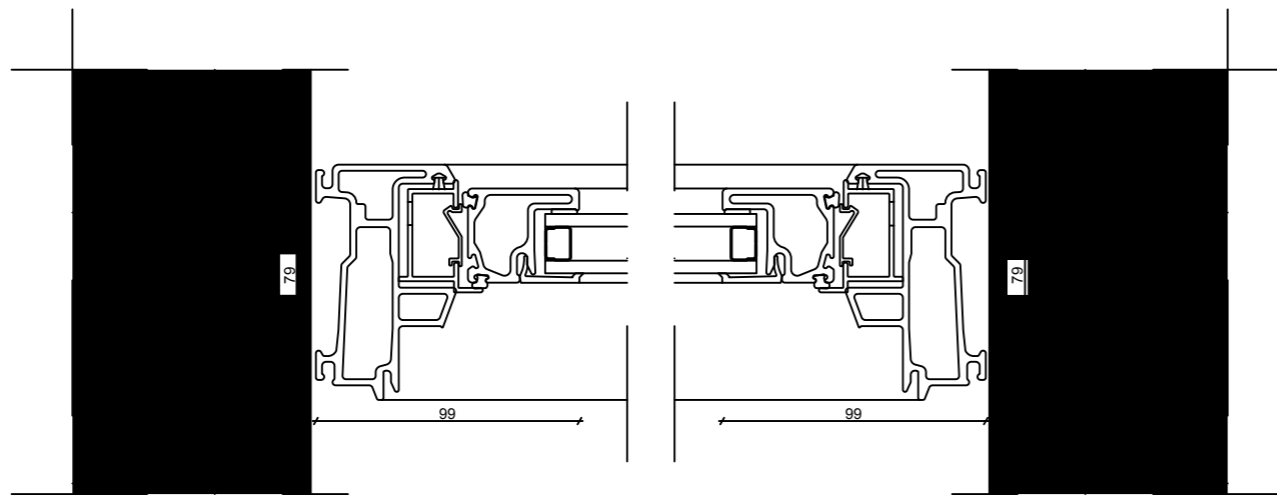
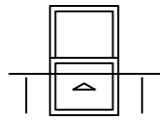

BWS 35

Sash 1

Vertical Section

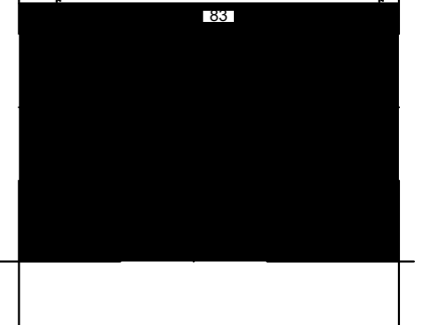
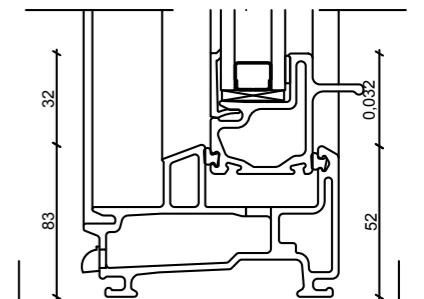
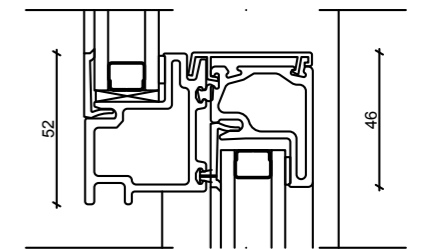
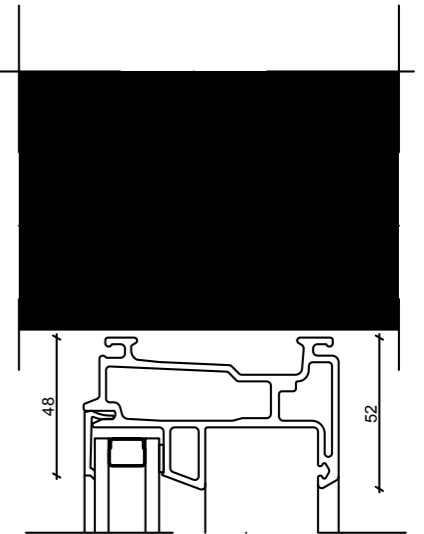
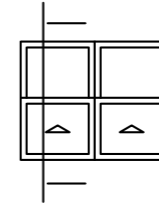

Horizontal Section

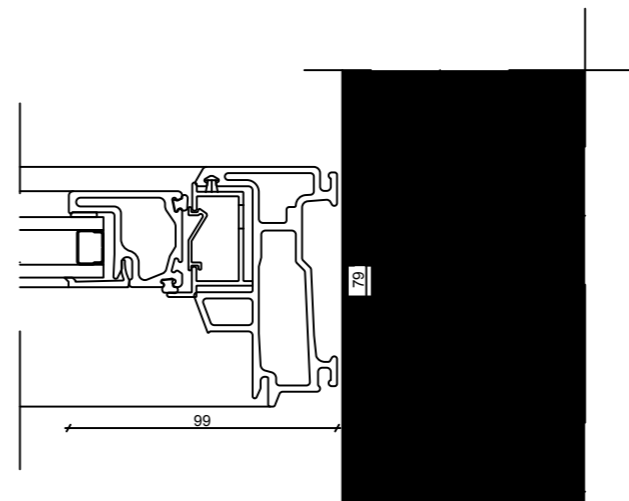
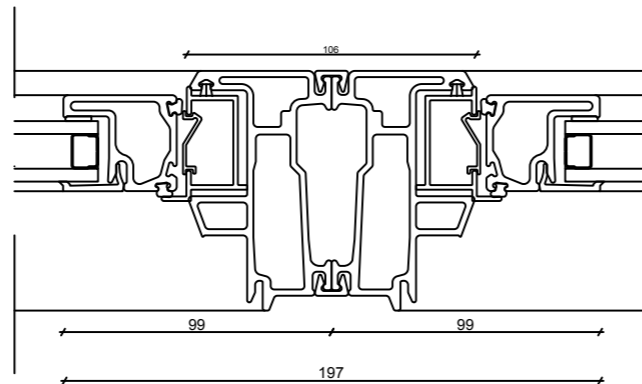
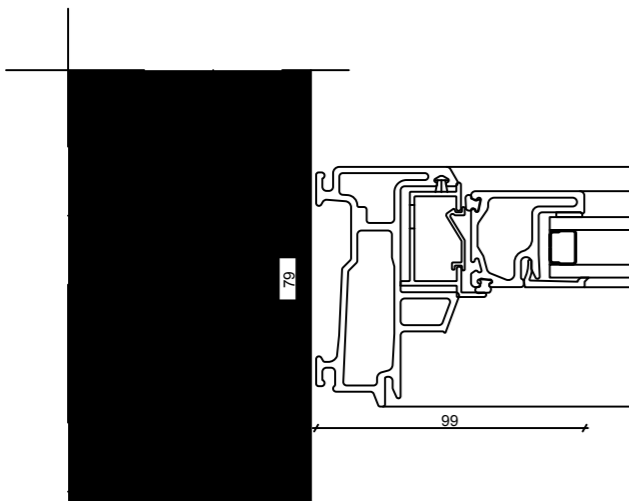
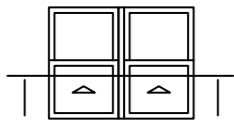

BWDS 35

Double Sash



- Max dimensions 1200 mm x 2000 mm;
- Glass thickness: 22mm and 28 mm
- Both panels open for cleaning;
- Allows mosquito net
- Latch as standard, lock as option

BWDS 35

Double Sash 2

Horizontal Section

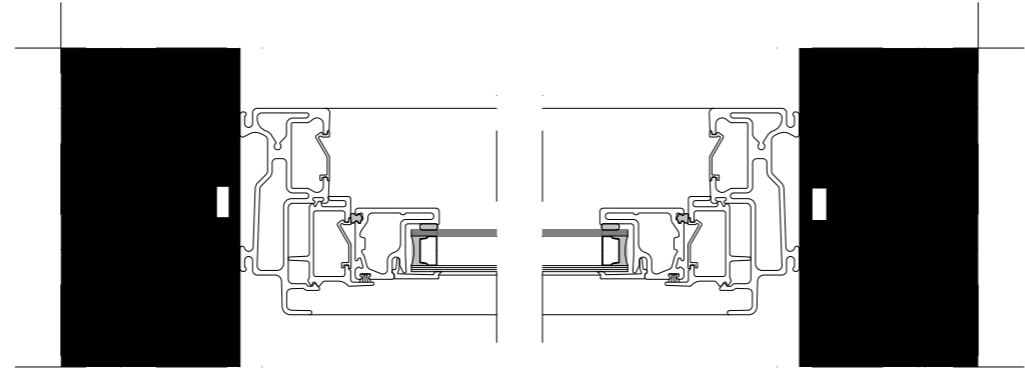
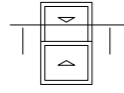

Horizontal Section

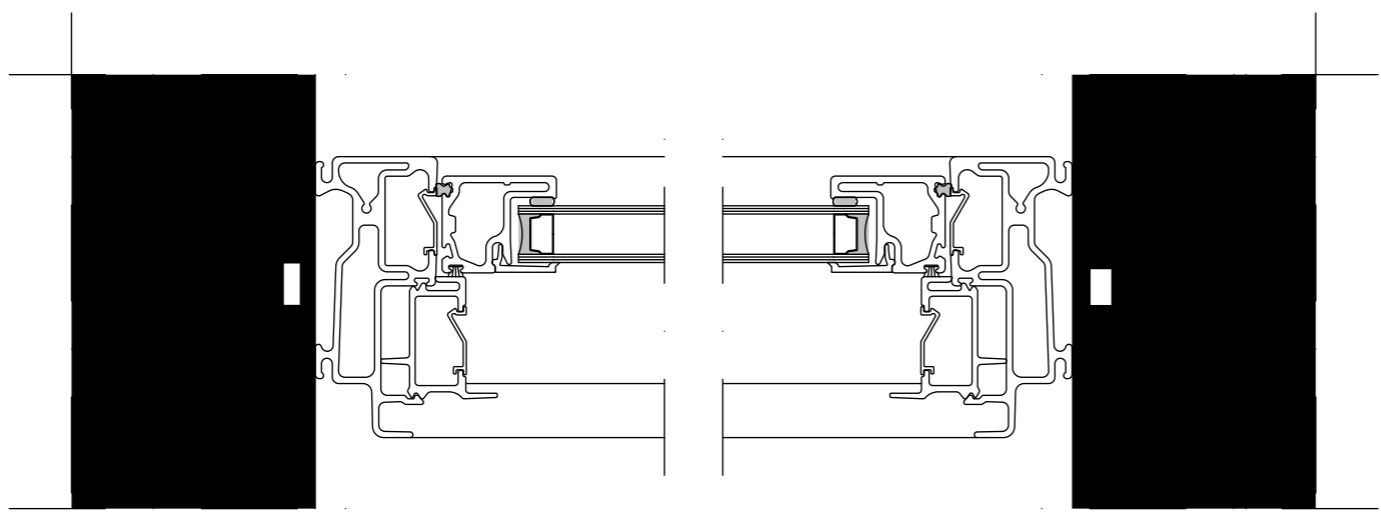
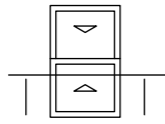

Vertical Section - Double Sash

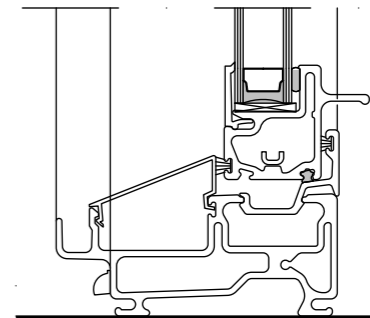
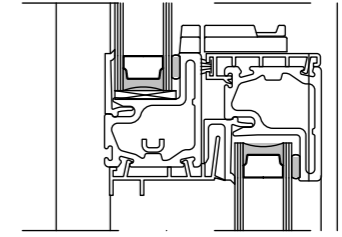
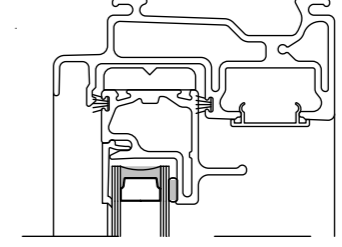
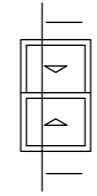

BWDS 35

Double Sash 2

Vertical Section - Double Sash

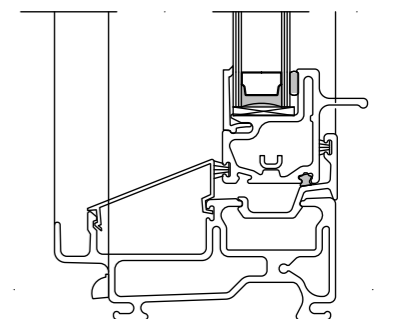
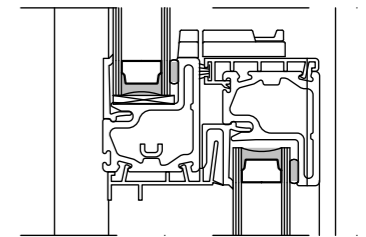
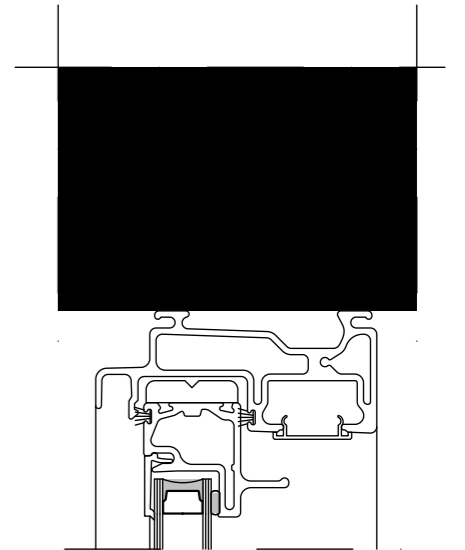
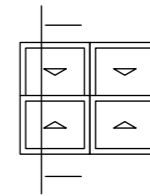

Horizontal Section

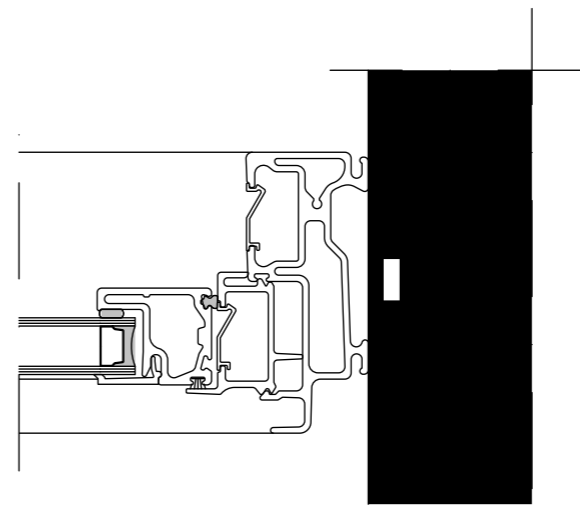
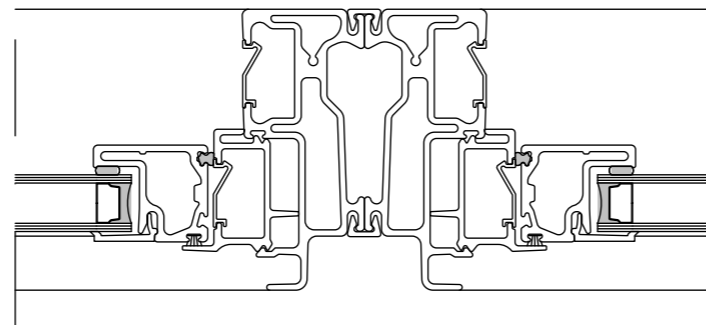
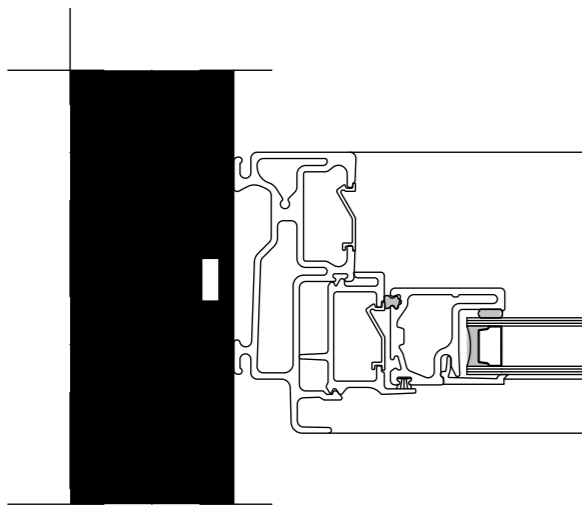
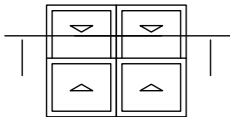

BWO 60

Outward Opening



- Two options: slim latch for Residential Projects; crank handle for hospitality projects
- Max dimensions: 1200mm x 2000 mm;
- Max weight 130 kg;
- Glass thicknesses: 22mm and 28 mm;
- Latch as a standard, lock as option
- BWO60 – FX – to be used with BWO60 only, cannot be used with other BW systems.

BW0 60

Side Opening

Vertical Section

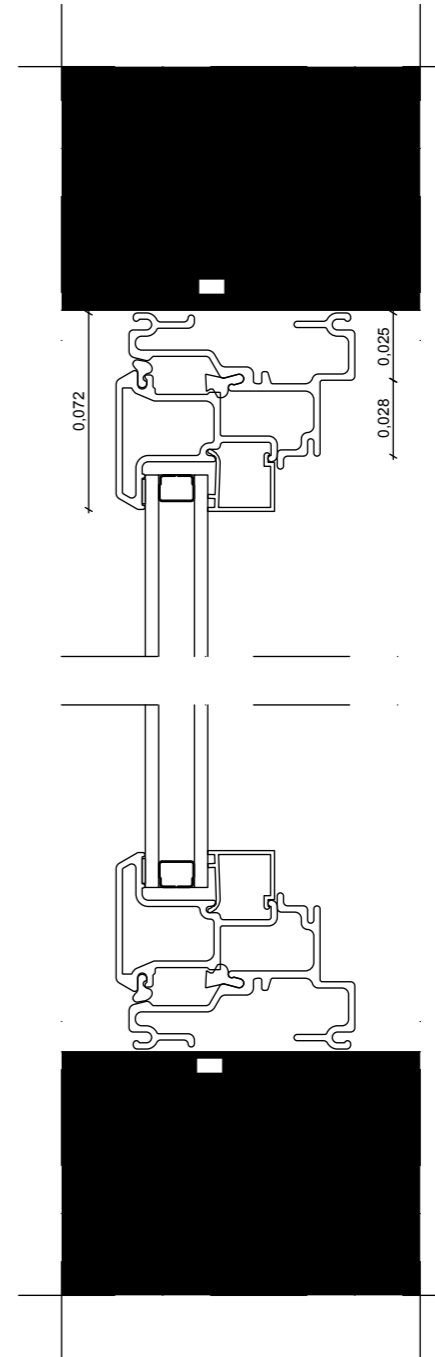

Horizontal Section

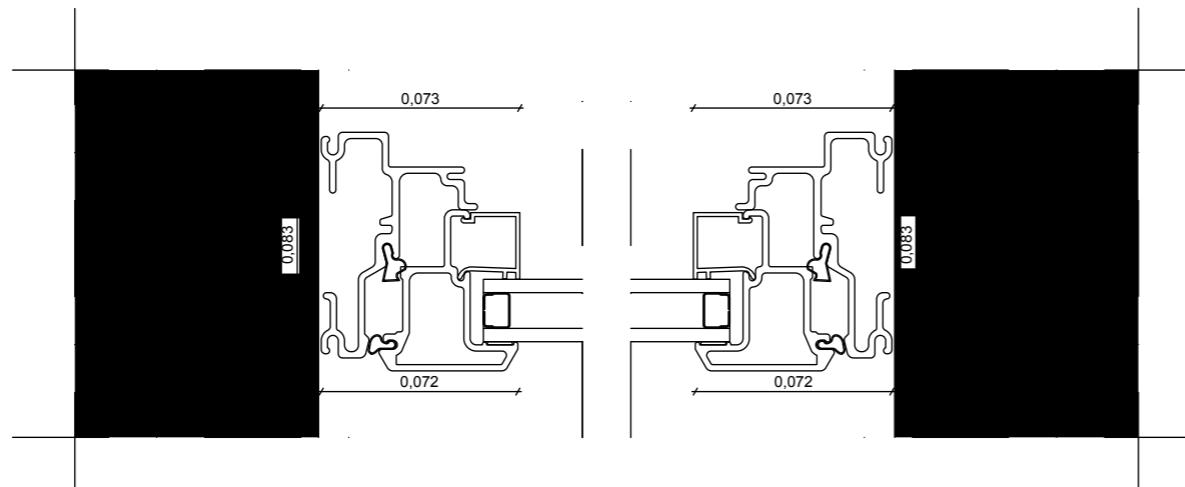
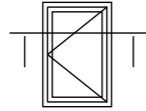

BW0 60

Fixed

Vertical Section



Horizontal Section

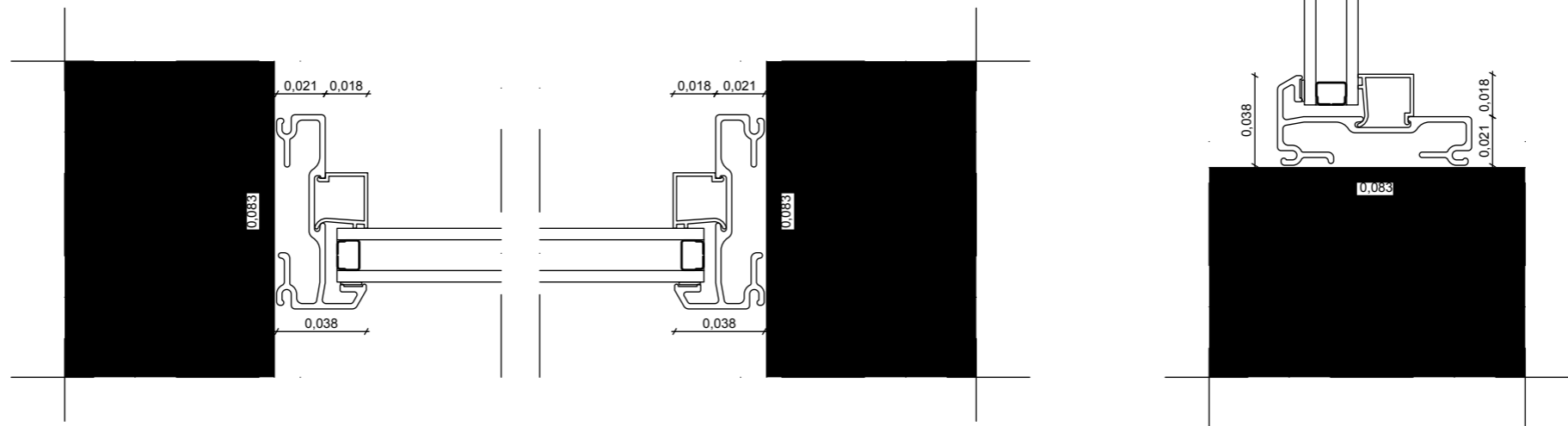
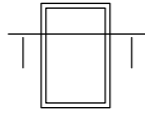

BW0 60

Top Opening

Vertical Section

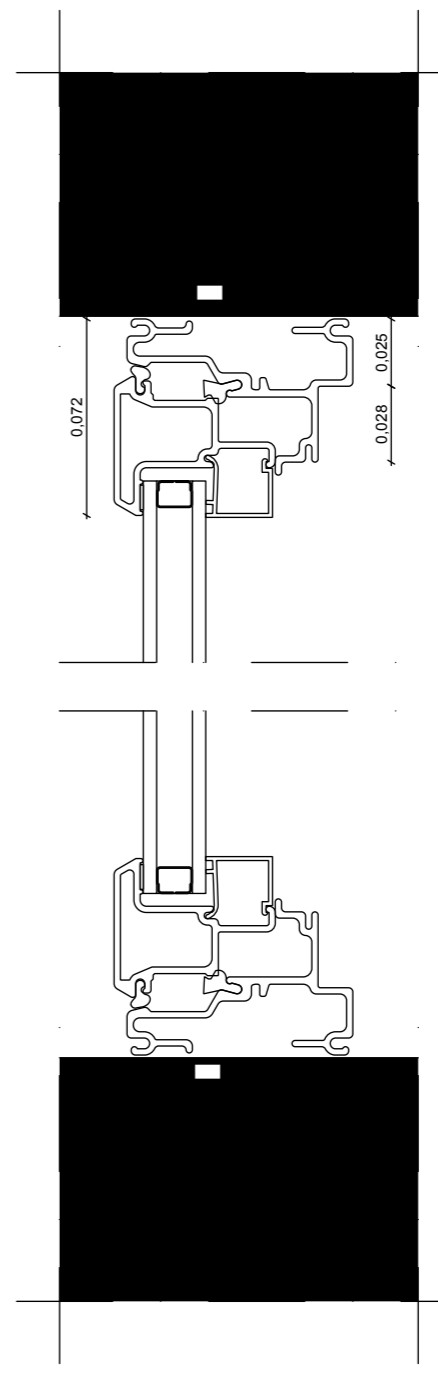

Horizontal Section

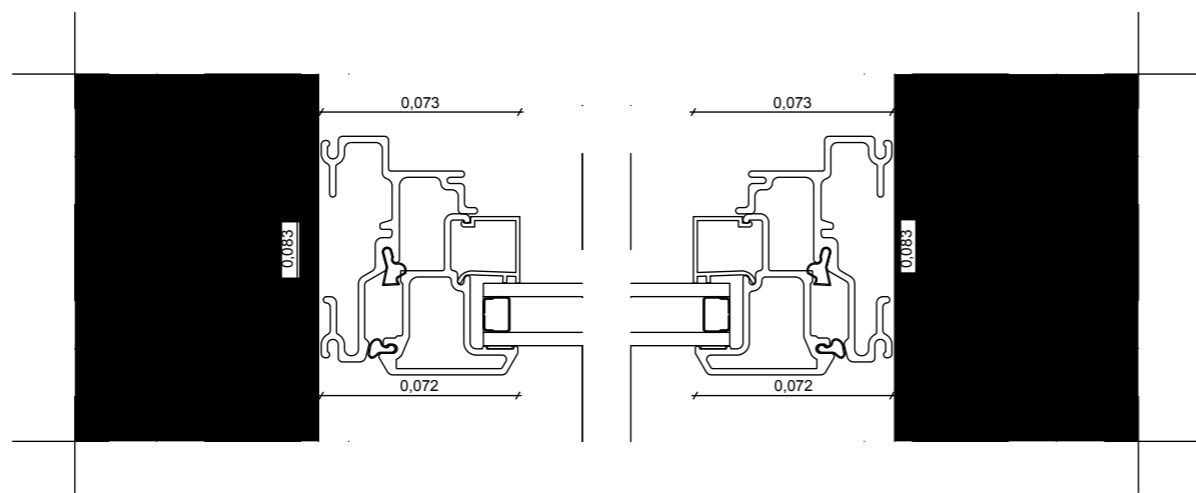
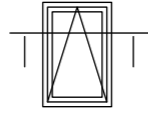

BW0 60 FX vc SO

Fixed vertical clip Side Opening

Vertical Section

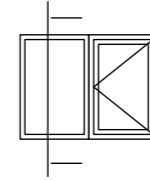

Horizontal Section

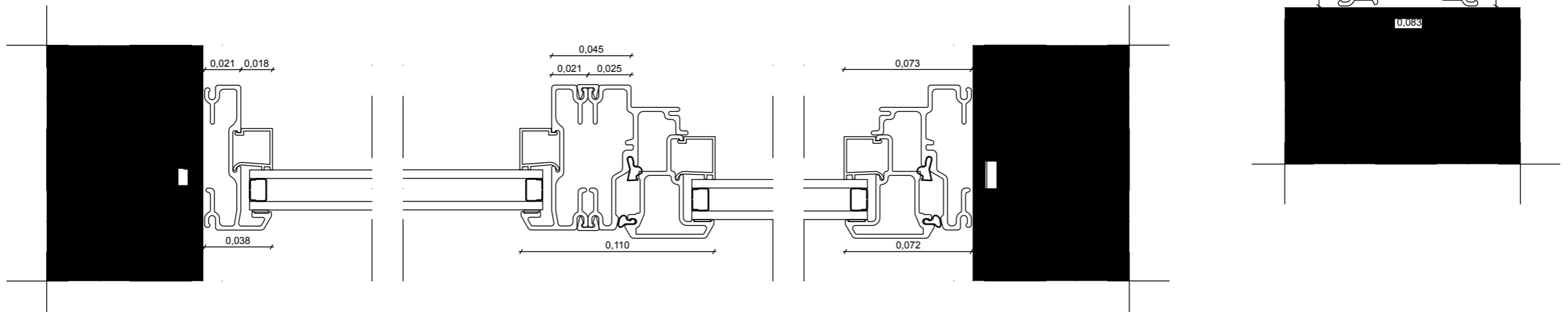
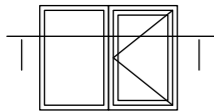

BW0 60 TO hc FX

Top Opening horizontal clip Fixed

Vertical Section

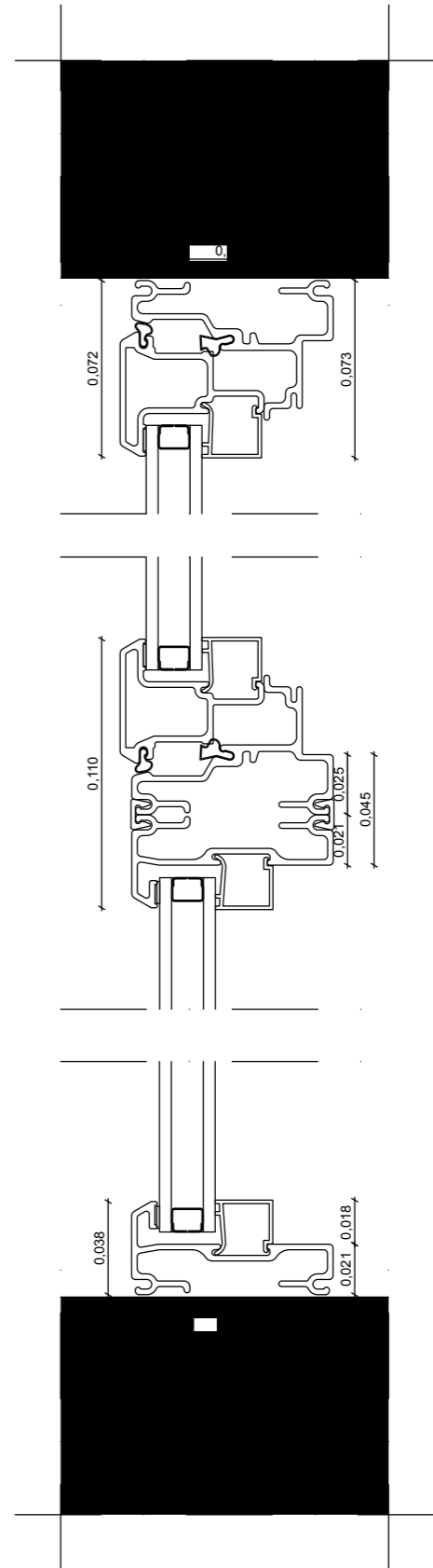
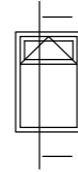

Horizontal Section

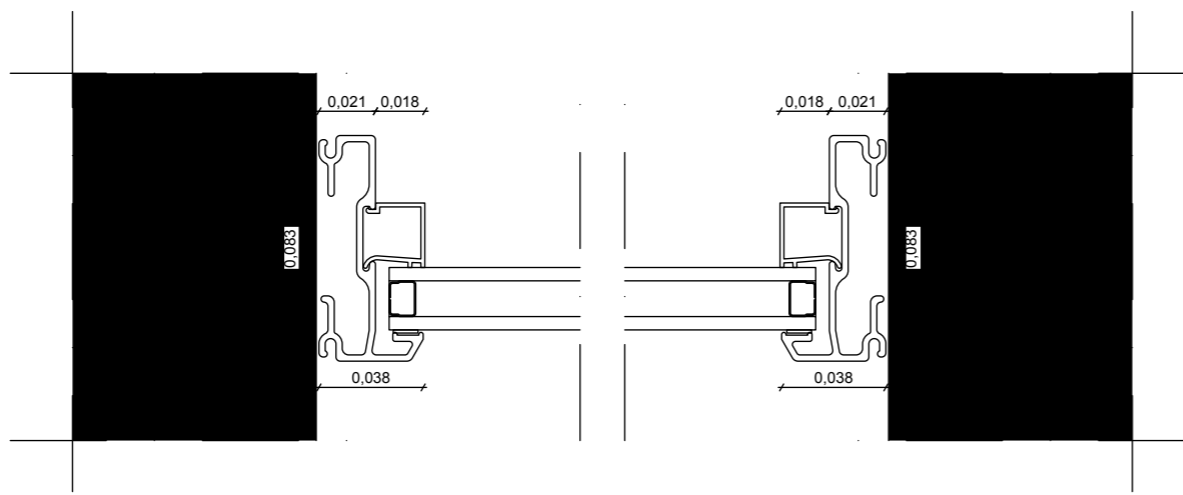
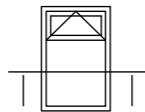



The choices we make define
who we are. Choose smarter,
think ahead!
Choose **BOAVISTA**



Boavista Windows
Rua Santa Apolónia 274
Armazém M
4410 - 022 Serzedo - V.N.Gaia
tel/fax +351 222 080 777
hello@fwdcomposites.com